

BERGEPANZER 2A2

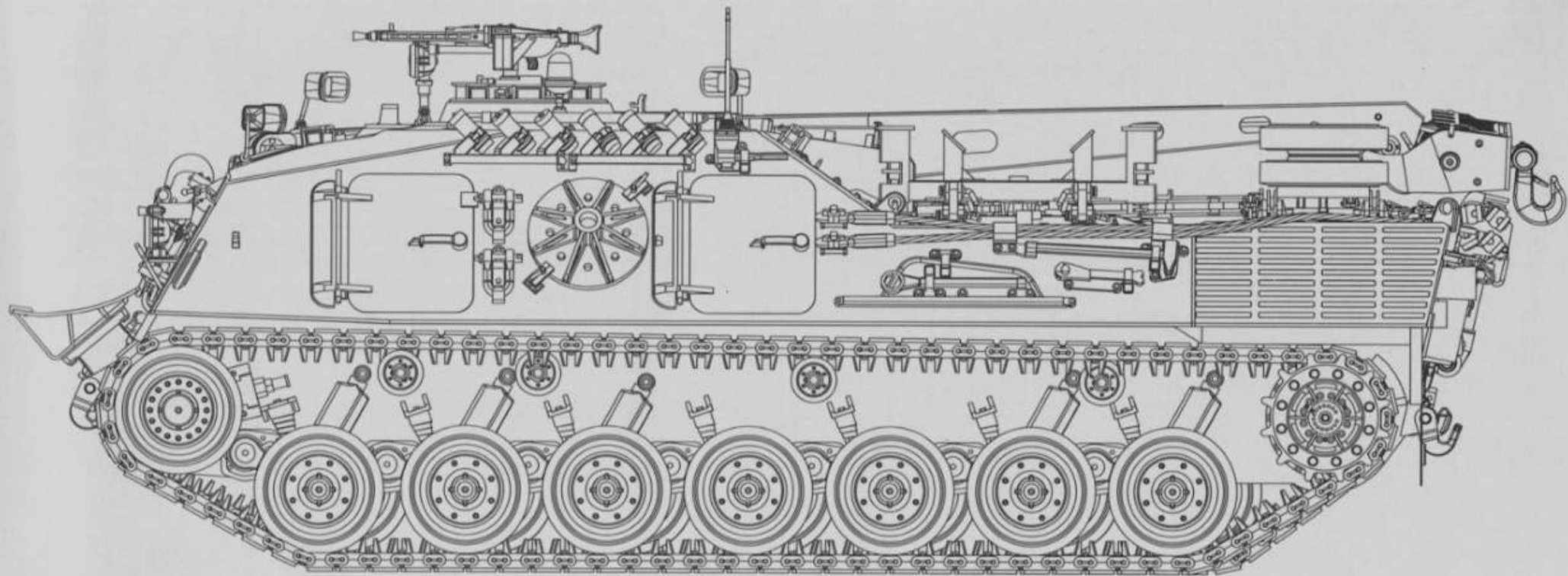

Based on the German Leopard 1 tank, the Bergepanzer 2 armored recovery vehicle was designed to ensure the mobility of armored forces by recovering & repairing damaged and broken-down Leopard tanks. These vehicles are operated by the logistical forces and tank grenadier companies of the Bundeswehr, as well as foreign operators of the Leopard 1 tank. Weighing in at 40.8 tons, some 480 units were produced between 1965-1969.

The vehicle is operated by a crew of 4: the commander, driver, machine gunner and radio operator. The welded construction offers the same protection as the Leopard 1, with 25-35mm thick armor at the sides and 10mm armor on the roof and offers NBC protection and a fire warning & suppression system. Combat protection is provided by a bow-mounted MG-3 and a roof-mounted MG-3AA gun, and six 76mm smoke grenade launchers. The Bergepanzer 2 is powered by an 830hp 10-cylinder MTU MB 838 CaM-500 multi-fuel engine pack reaching a top speed of 62 km/h with a range of 850km.

The vehicle is equipped with a boom for lifting turrets & engines in & out of tanks, as well as a spade & winch system for recovering bogged down vehicles. Produced in 1977-78, the Bergepanzer 2 A2 was developed to service the heavier turrets of the Flakpanzer Gepard and the Leopard 2 and features a hydraulic stabilizer on the rear right corner.

READ BEFORE ASSEMBLY

CAUTION

- Read carefully and fully understand the instructions before commencing assembly. A supervising adult should also read the instructions if a child assembles the model.
- When assembling this kit, tools including knives used. Extra care should be taken to avoid personal injury.
- Keep out of reach of small children. Children must not be allowed to suck any part, or pull vinyl bag over their heads.



PAINTS REQUIRED

Color info and profiles by Mig Jimenez

A.MIG-0001 Rubber & Tires	A.MIG-0002 Dark Tracks	A.MIG-0003 New Wood	A.MIG-0004 Gun Metal
A.MIG-0005 Satin Black	A.MIG-0006 Silver	A.MIG-0007 Crystal Glass	A.MIG-0008 Crystal Red
A.MIG-0009 Crystal Orange	A.MIG-0010 Crystal Blue	A.MIG-0011 Nato Green	A.MIG-0012 Nato Brown
A.MIG-0013 Matt Black	A.MIG-0014 Old Wood	A.MIG-0015 Light Wood	A.MIG-0016 Gelbohn IAL 6014
A.MIG-0017 Rd 101779 German Sand Bridge	A.MIG-0018 White Camo		

APPLYING DECALS

1. Clean the model surface with a wet cloth.
2. Cut out each decal design from sheet, and dip it in tepid water for 15-20 sec.
3. Hold the backing sheet edge and slide decal onto the model.
4. Move decal into position by wetting decal with finger.
5. Press decal gently down with a soft cloth until excess water and air bubbles are gone.

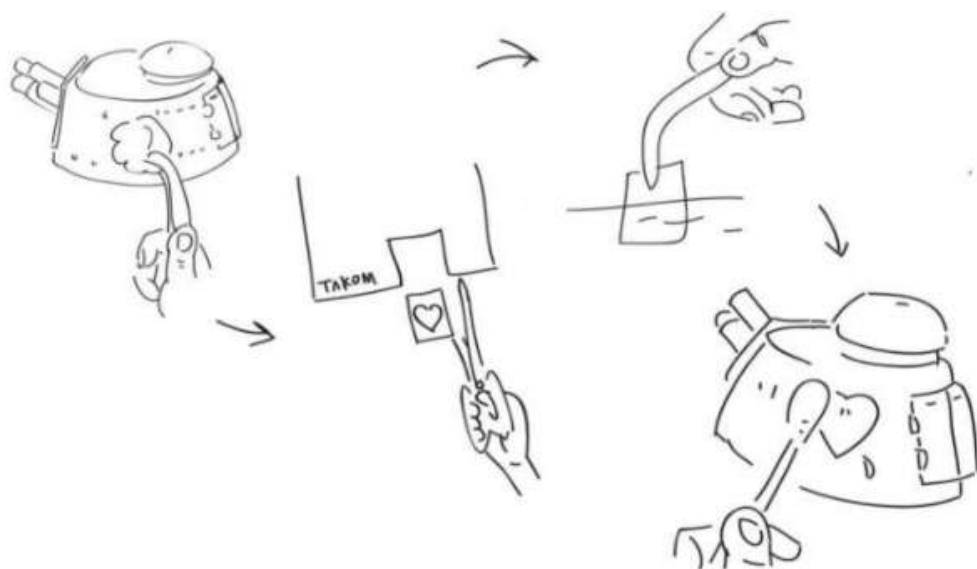

REMOVING PE

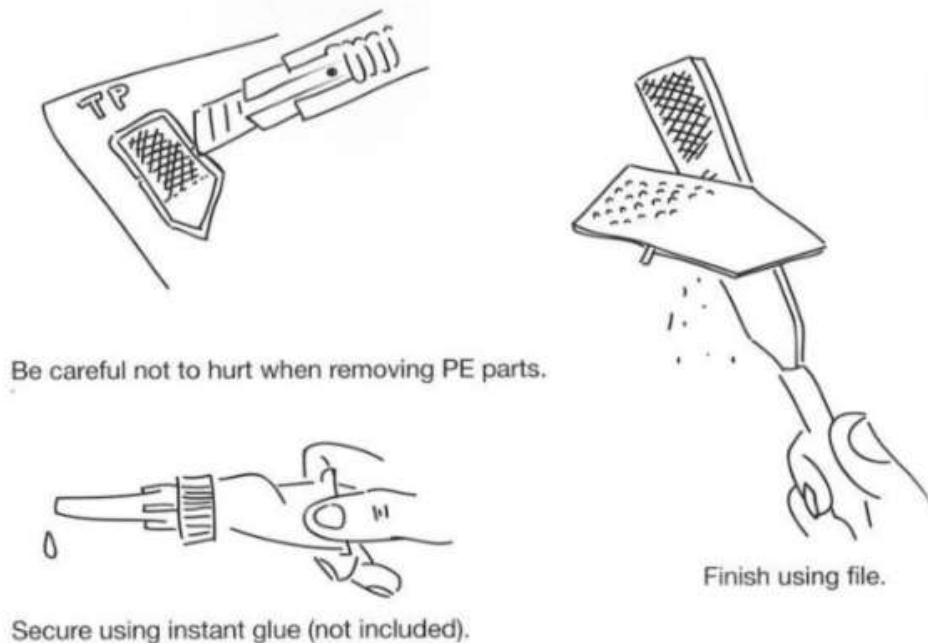

PARTS

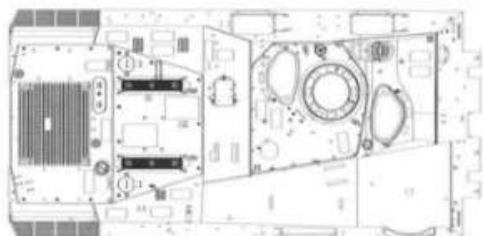
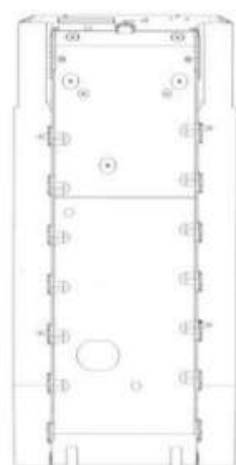
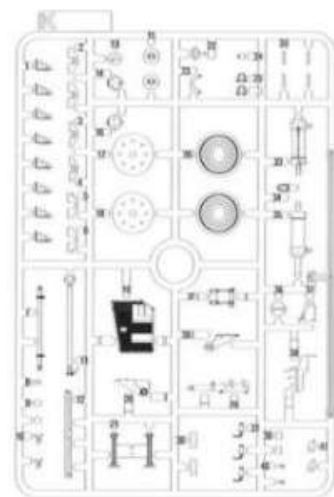
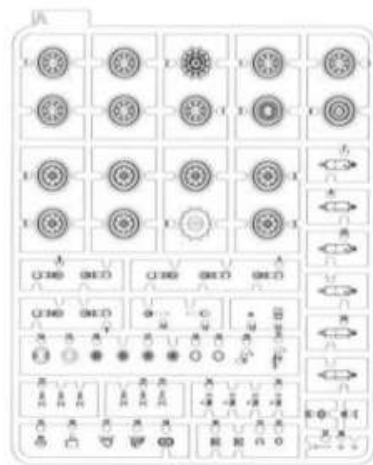
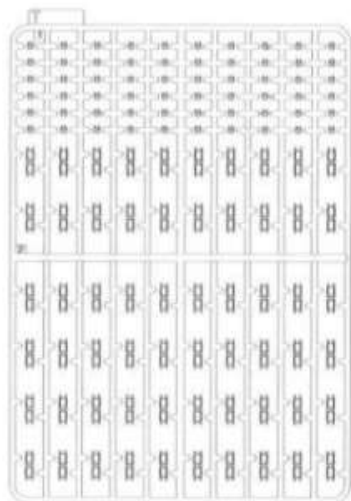
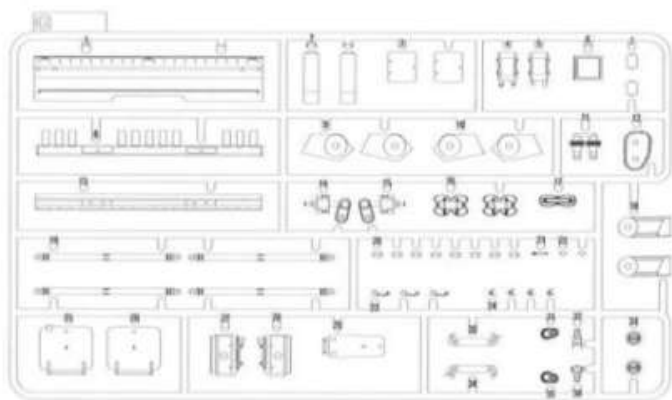
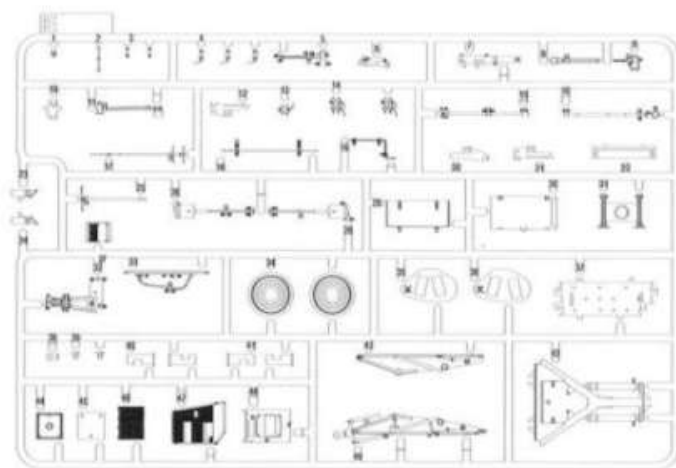
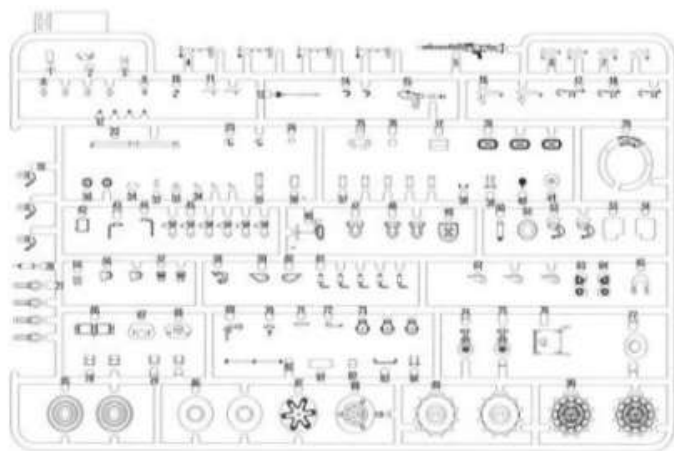
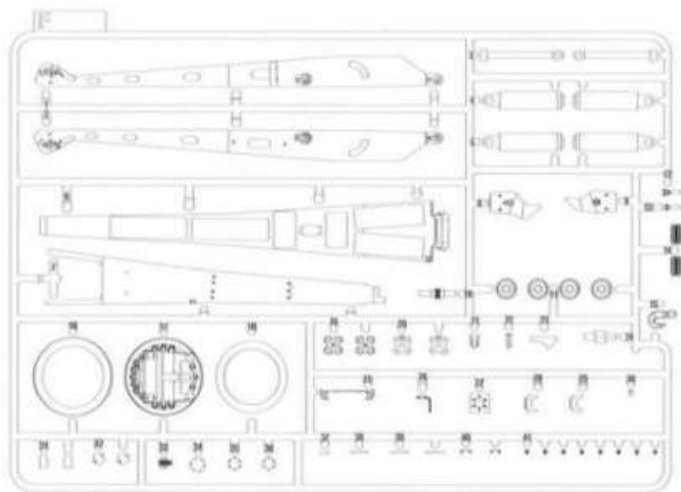

Upper Hull

X3

X2

Lower Hull

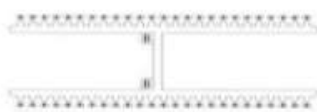

Poly Cap B X6



Nylon Rope
Cable

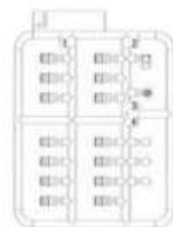

TP



Decal

4

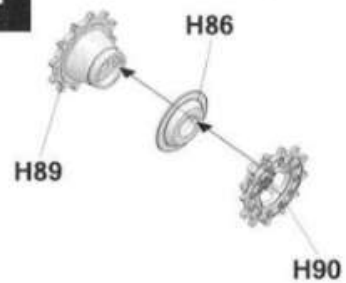

Make 2

A



Make 2

B



Make 14

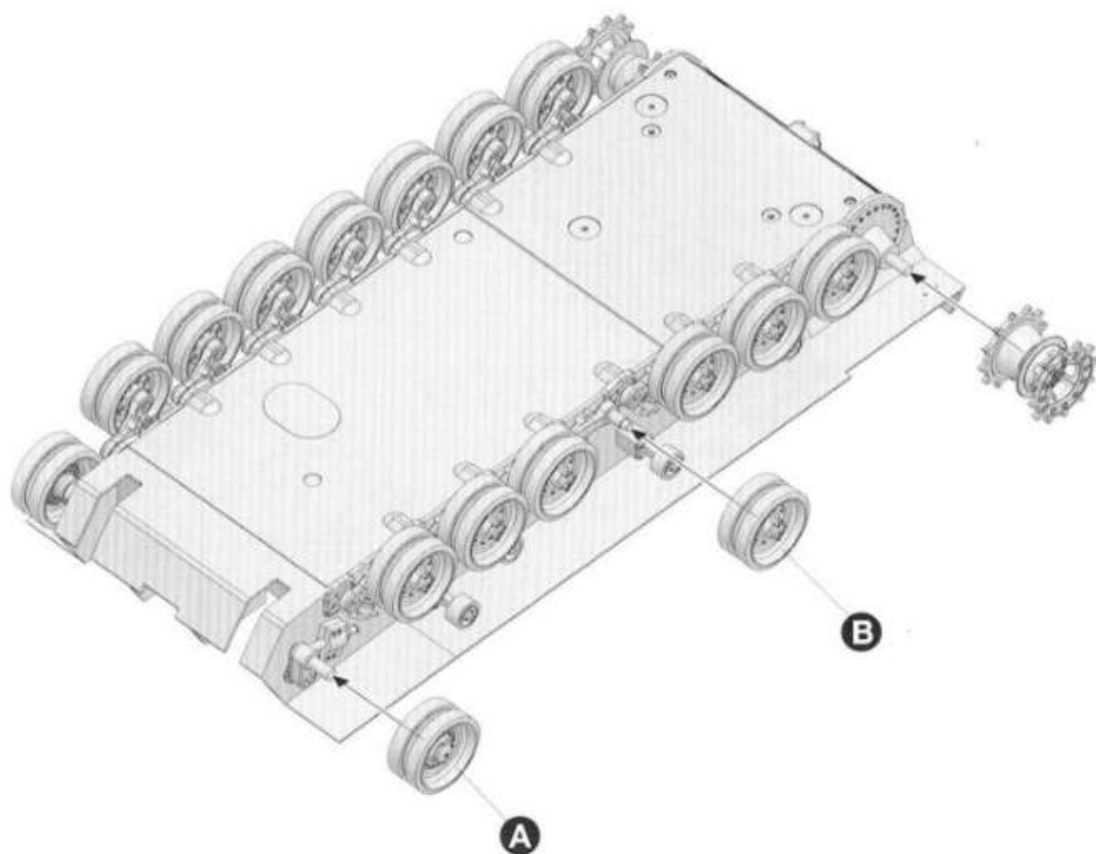

5

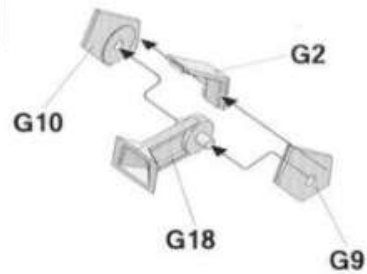

Make 2

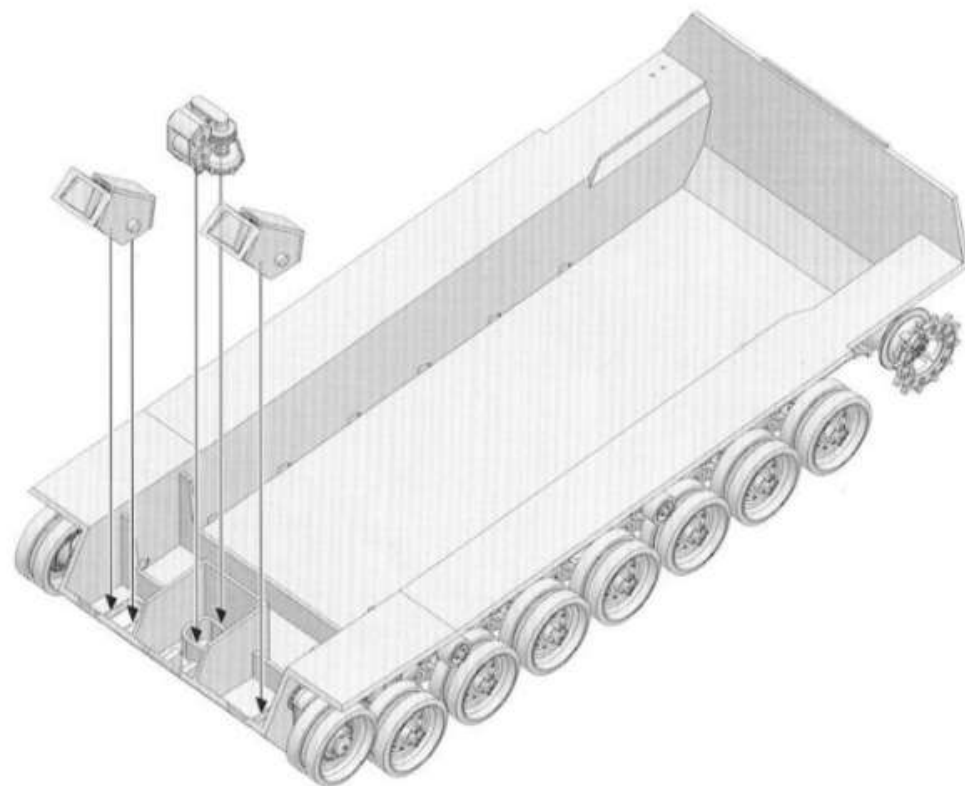
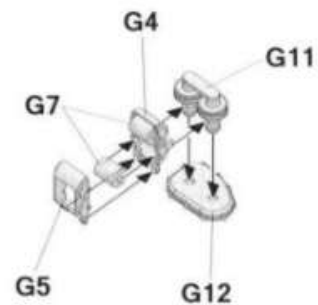

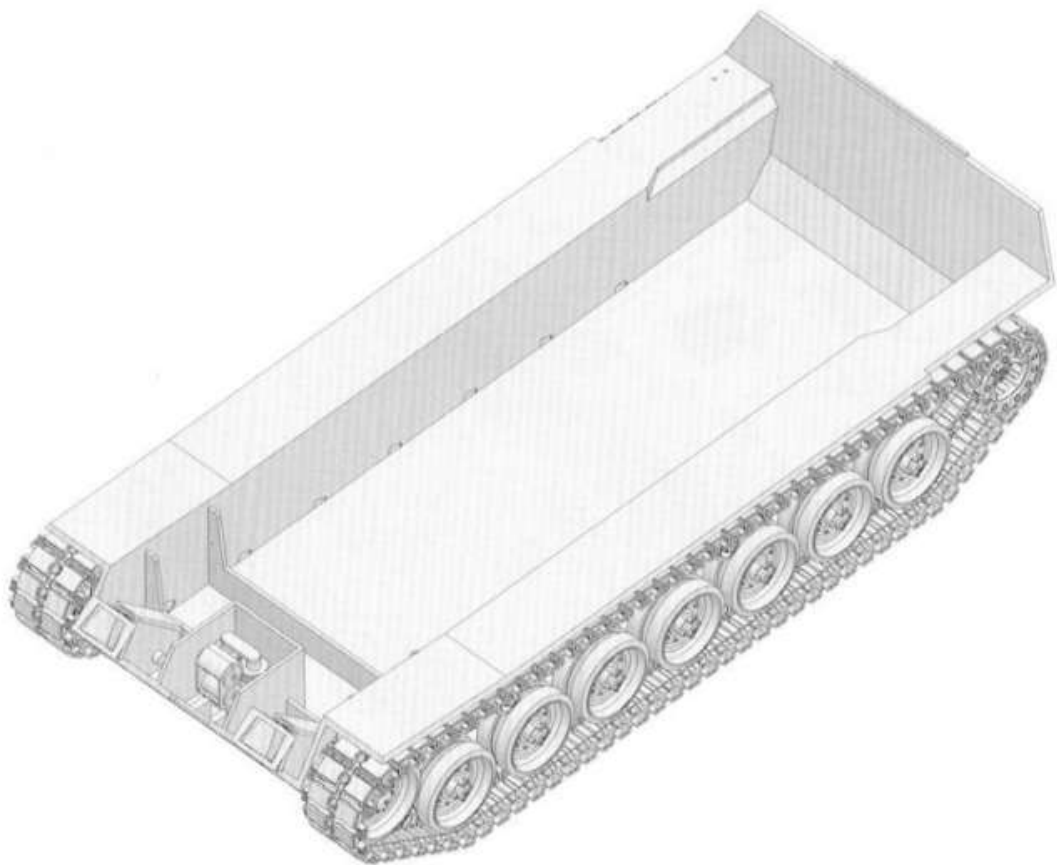
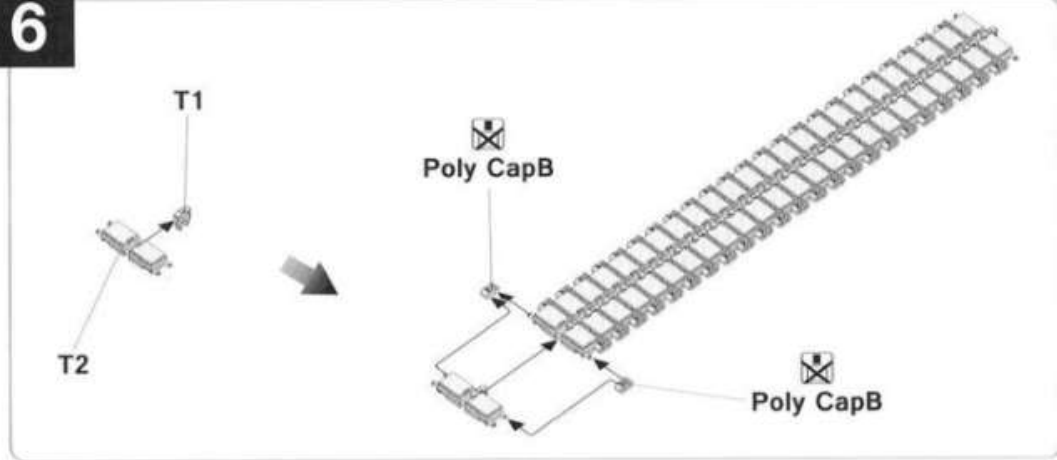
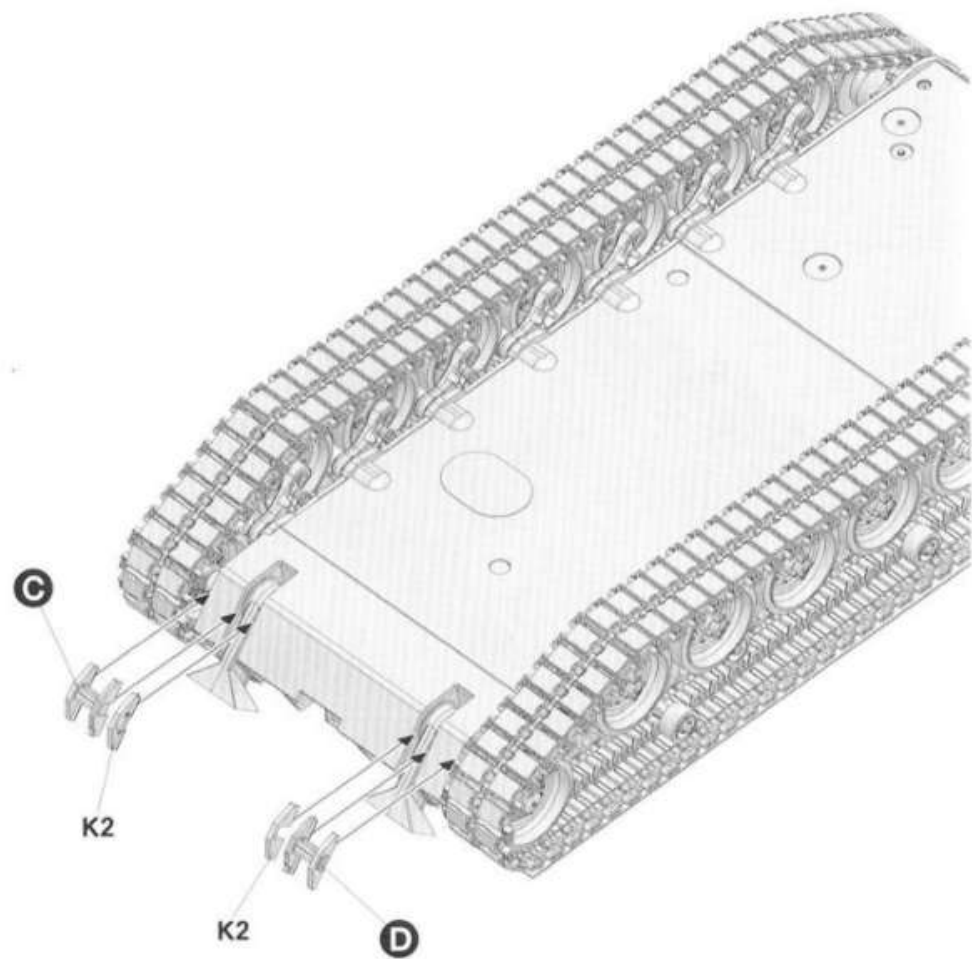
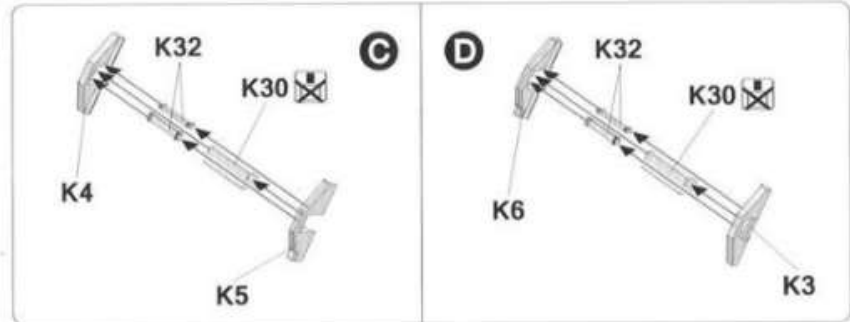
6**7**

8

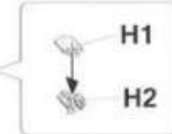
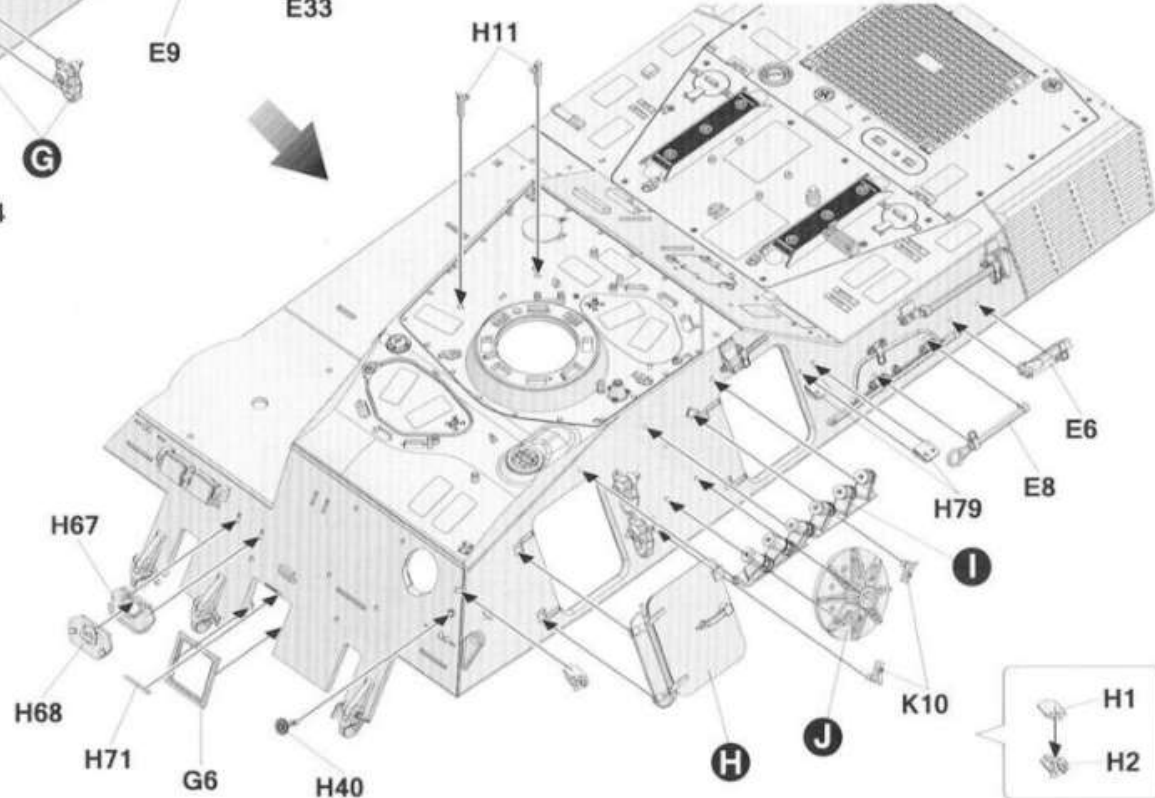
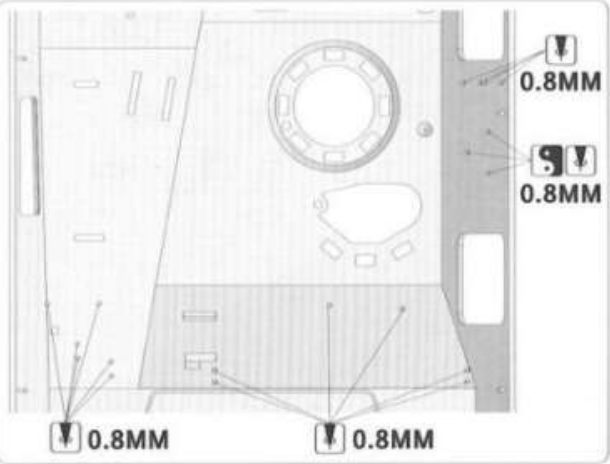
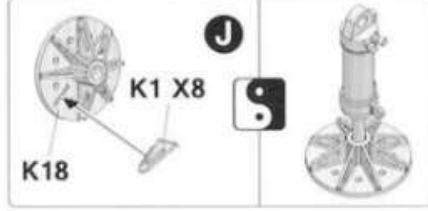
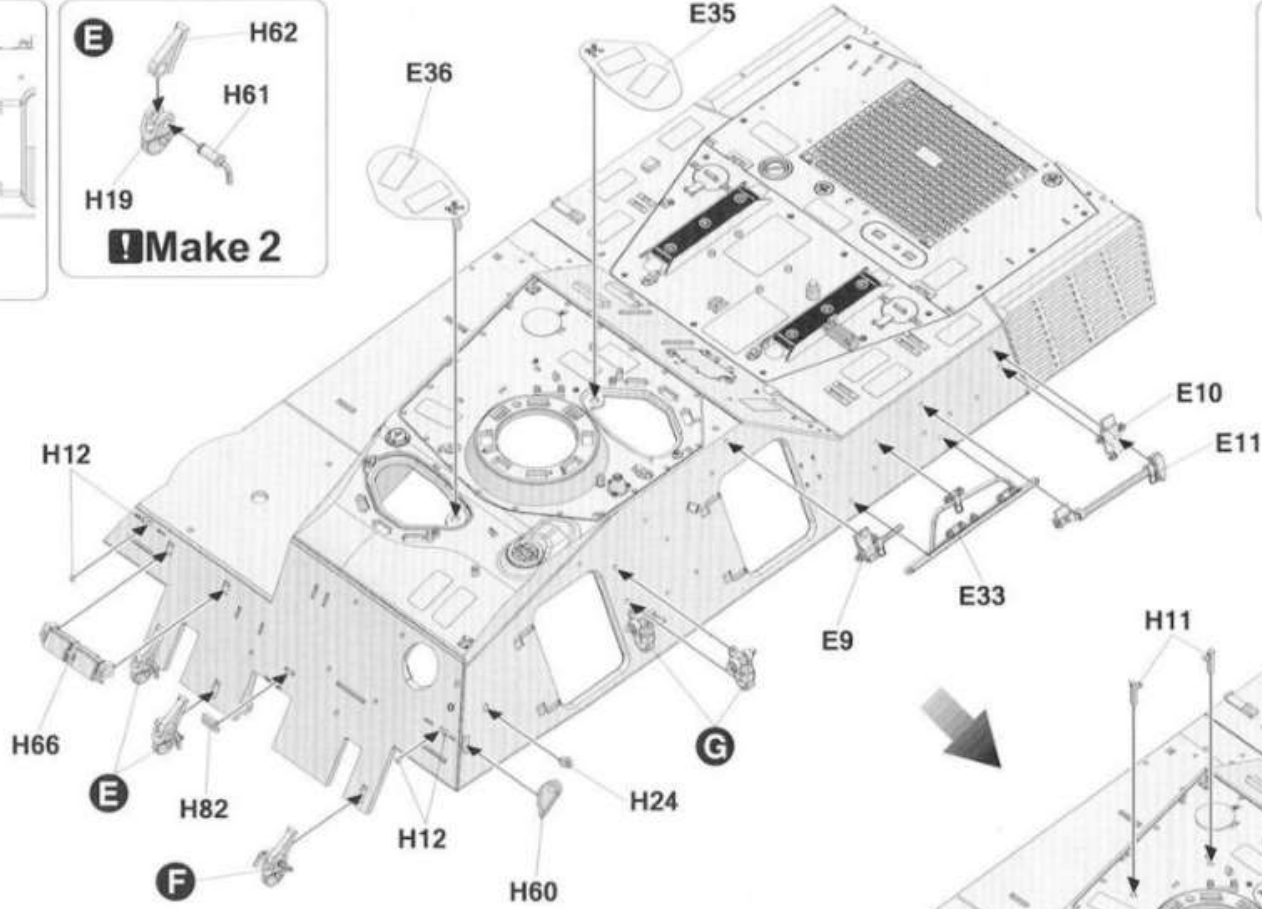
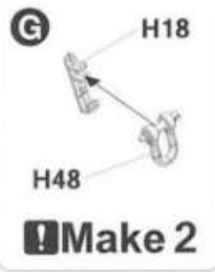
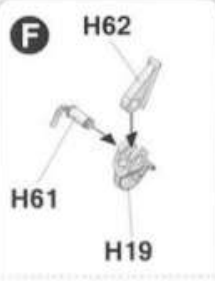
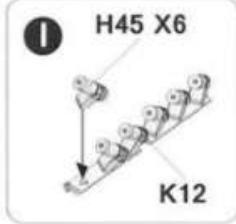
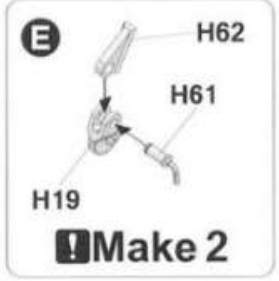
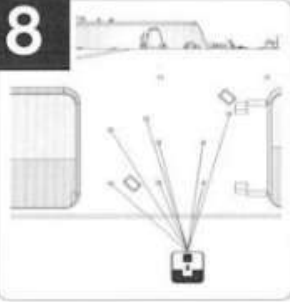

9

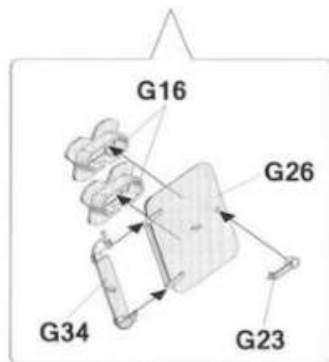
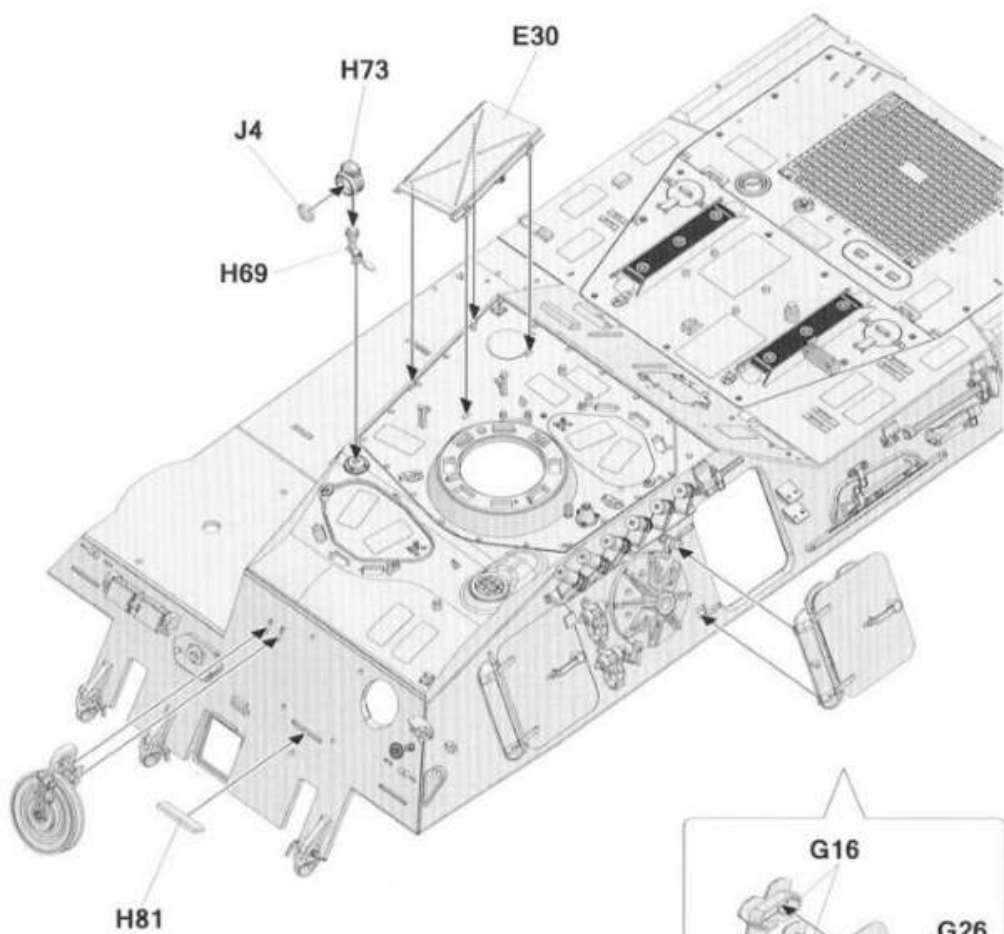
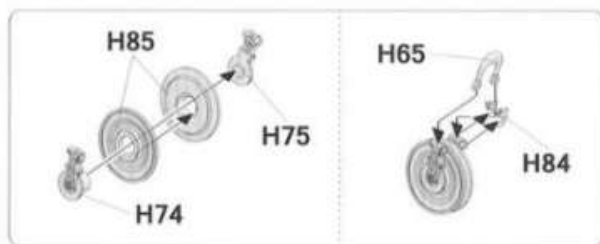

10

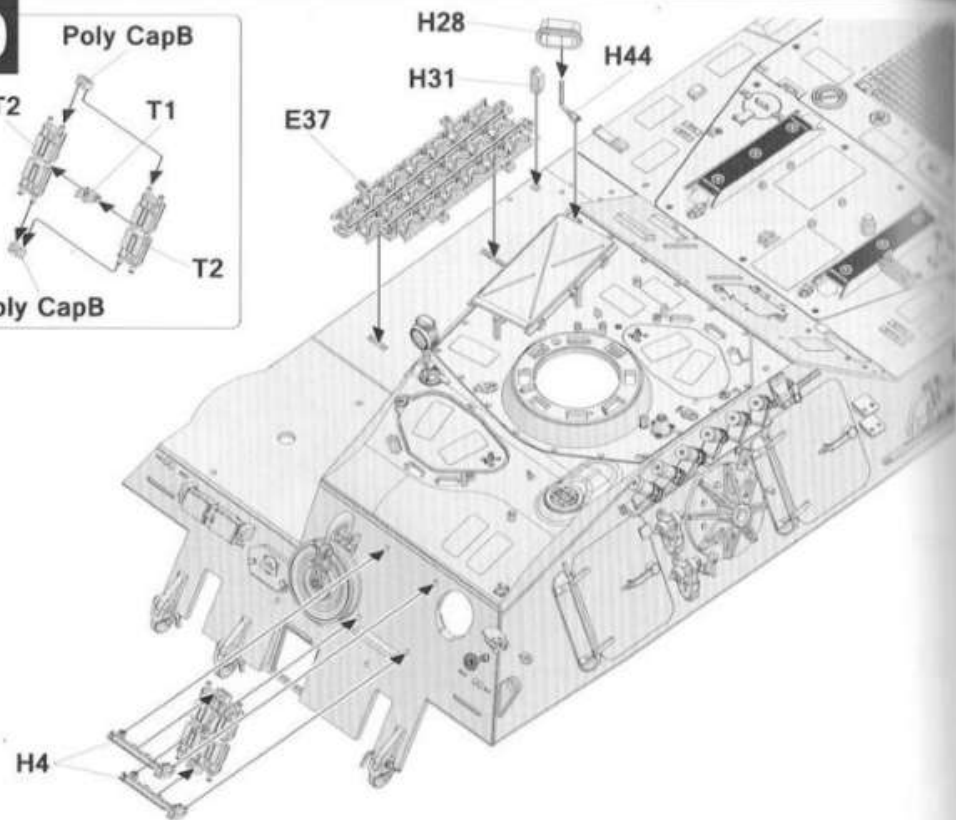
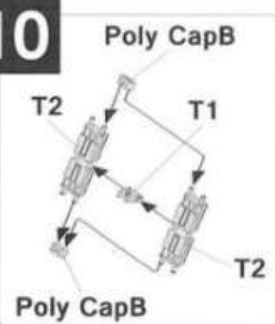

11

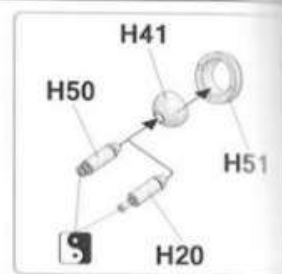
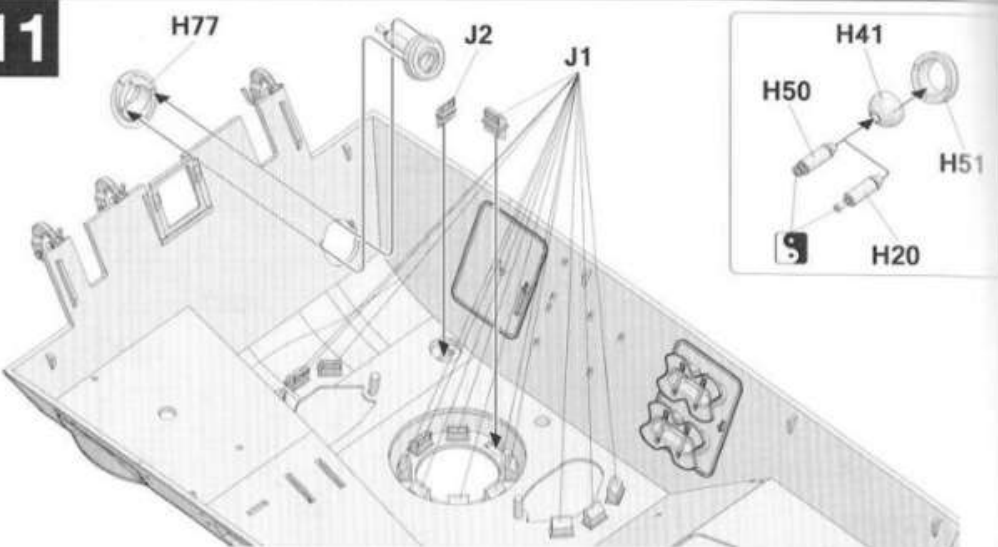

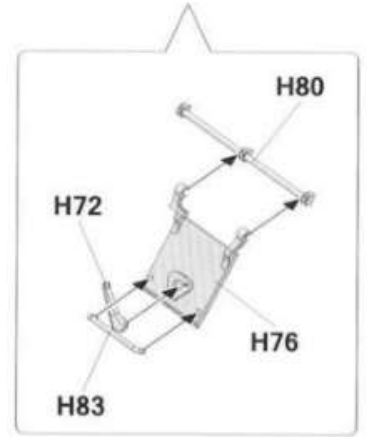
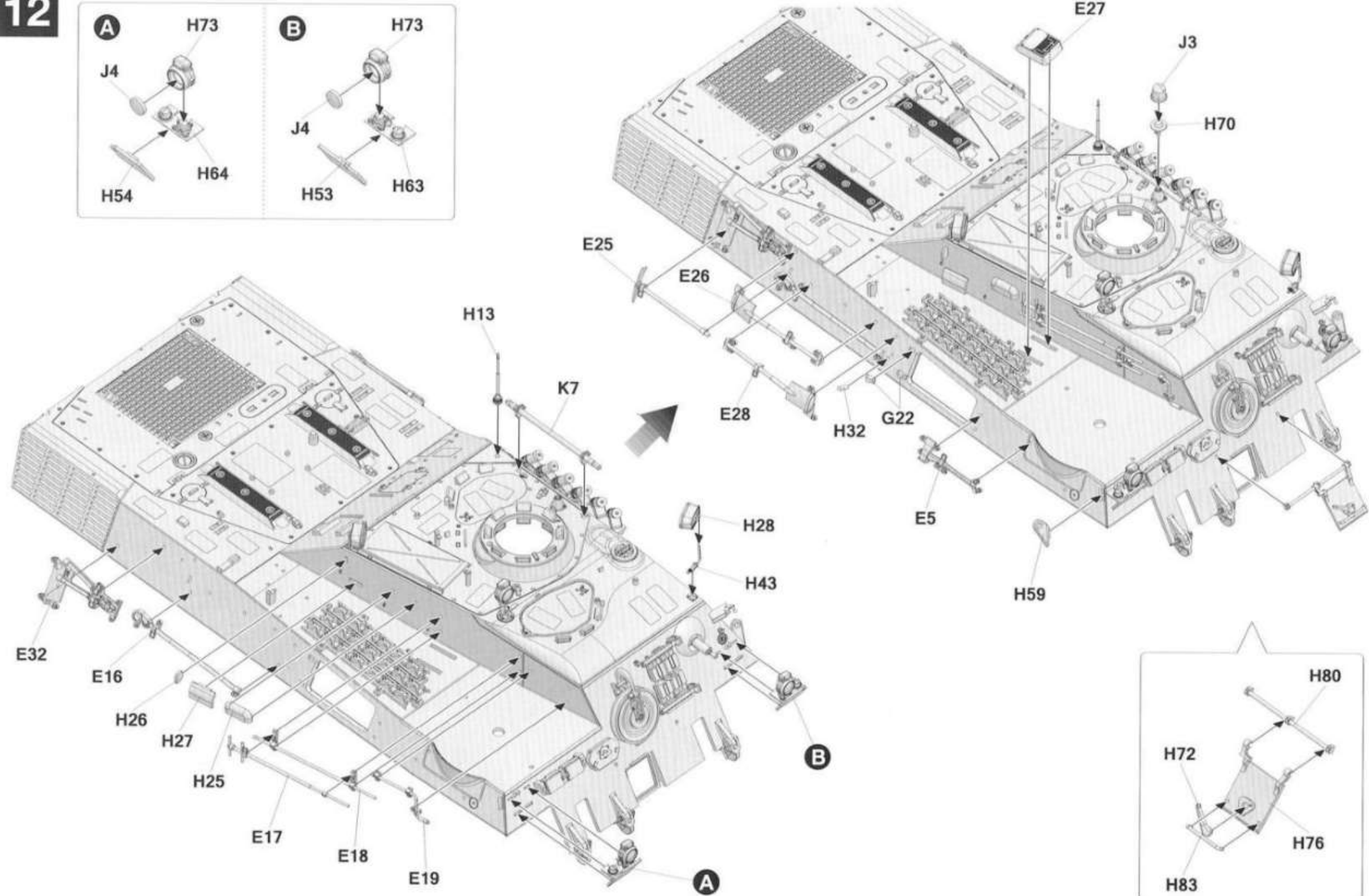
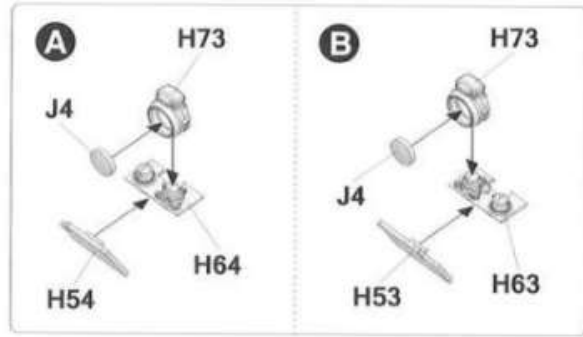

13

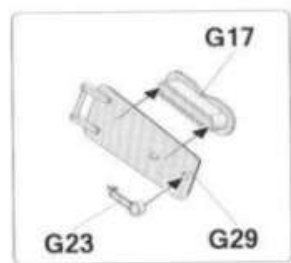
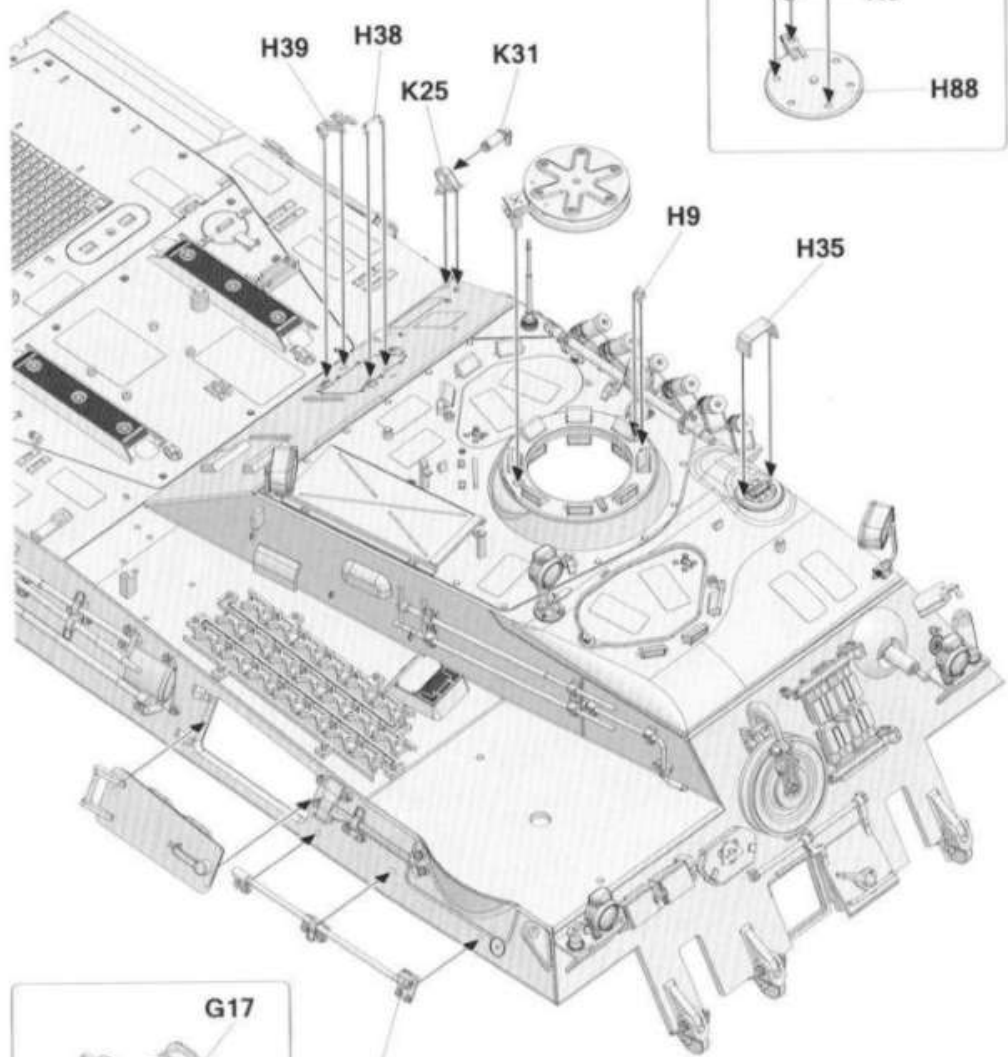

14

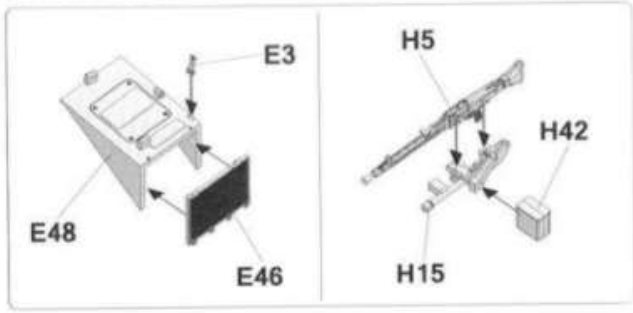
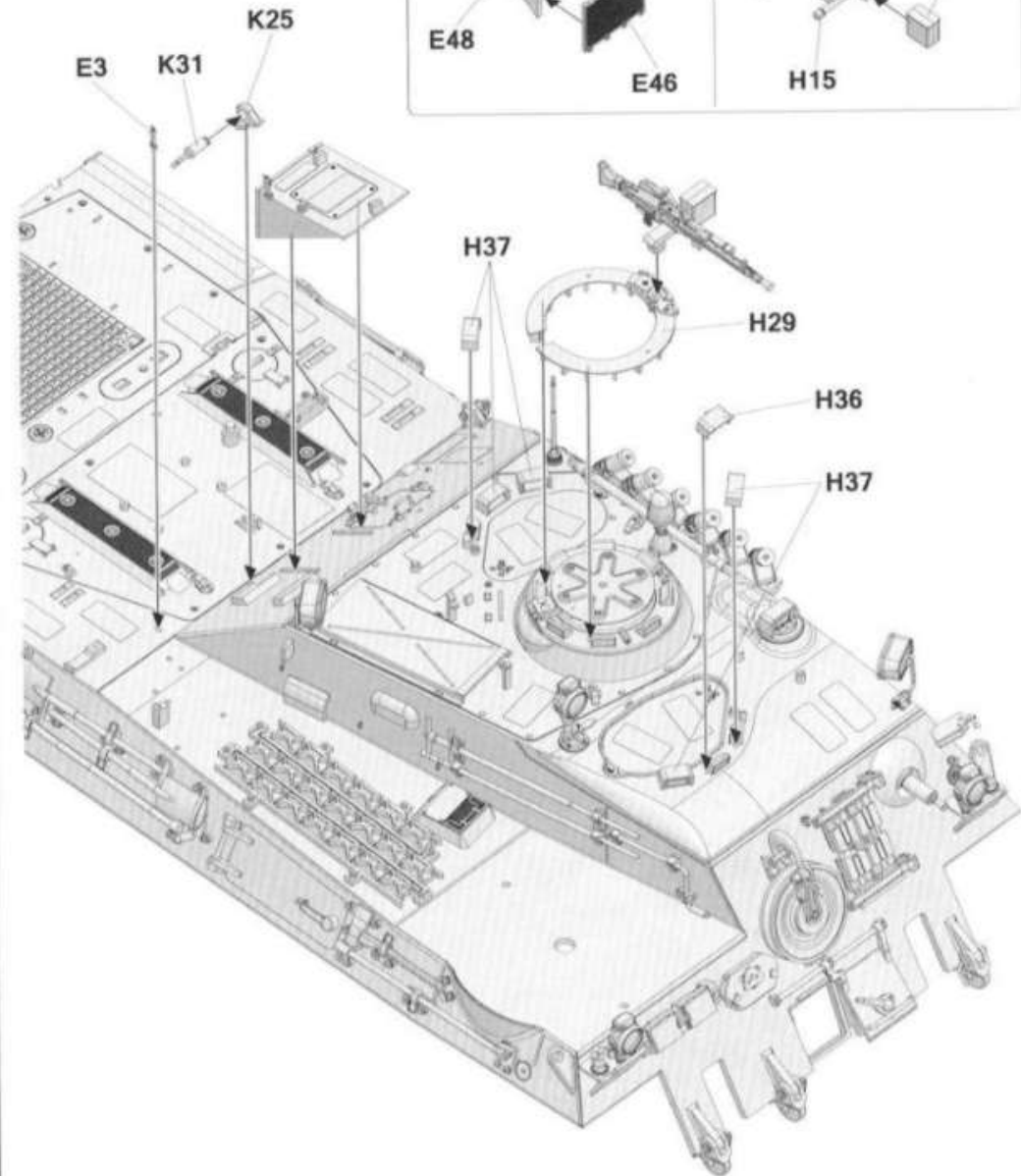

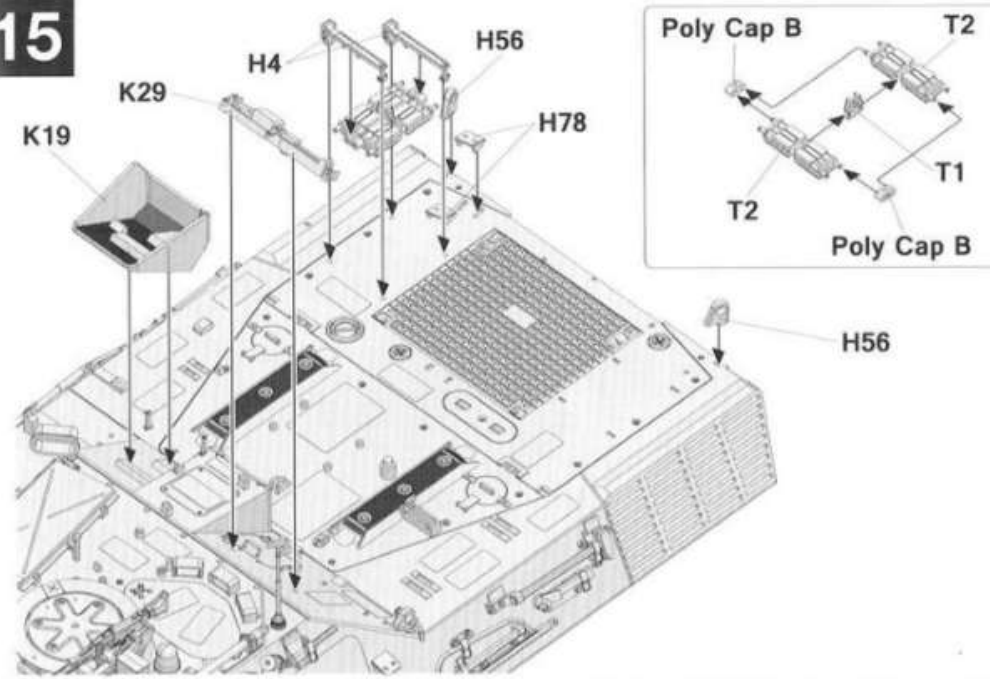
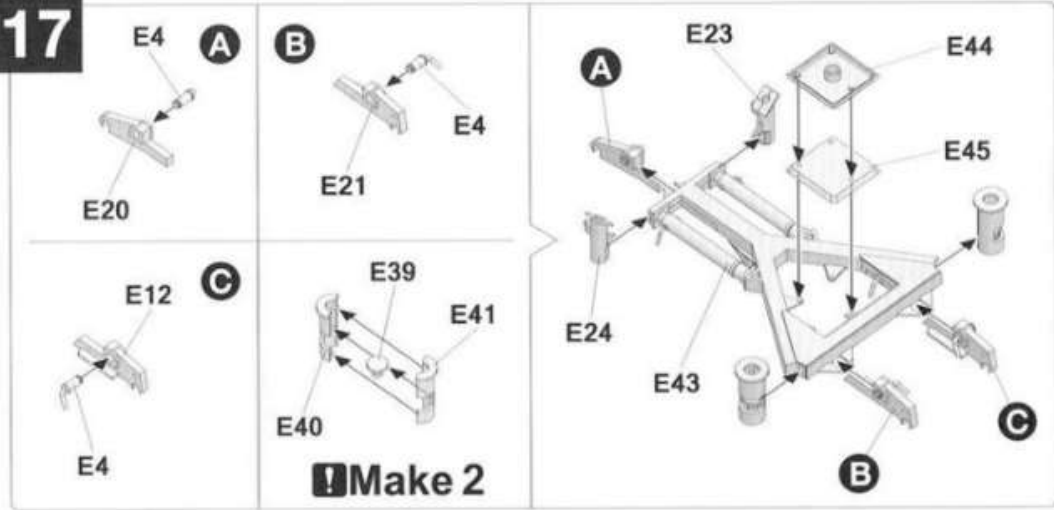
15**17****16**