

BÜSSING-NAG 500 A



Cat. no. 35011

Scale 1/35



Project, design & artwork: Jarosław Leoniec
Research: IBG crew

- ▲ 1 Element złożony we wcześniejszym etapie
Element assembled in previous step
- ▲ 1 Element po złożeniu w aktualnym etapie
Element after assembly in actual step
- ▲ ? Wersja do wyboru
Version to choose
- ▲ 1 Kalkomania
Decal
- ▲ A Kolor farby
Paint colour
- Część nie do użycia
Part not for use

		Gunze Mr.Color	Model Master Acrylic	Humbrol	Valleyo MC
black	▲ A	C002	4695	21	861
wood	▲ B	C043	4673	110	846
gunmetal	▲ C	C104	4681	53	863
panzer gray	▲ D	C040	4795	67	995
rust	▲ E	C029	4675	113	846
leather	▲ F	C019	4674	62	843

Przed montażem przeczytać instrukcję. Przestrzegać kolejności montażu podanego w instrukcji! Klej i farby nie wchodzi w skład zestawu.

Please read instruction before assembly. Obey sequence of assembly like in instruction. Glue and paints not included.

Ramka przezroczysta / Frame clear

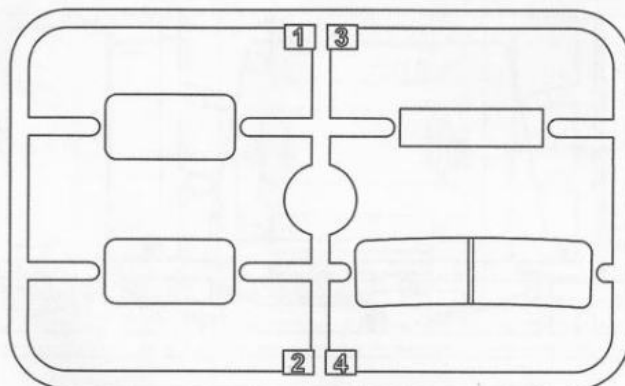

International Business Group
ul. Benedykta Hertza 2
04-603 Warszawa
Poland

tel +48 22 8159150
fax +48 22 8159151
ibgsc@ibg.com.pl
www.ibg.com.pl

Ramka D / Frame D

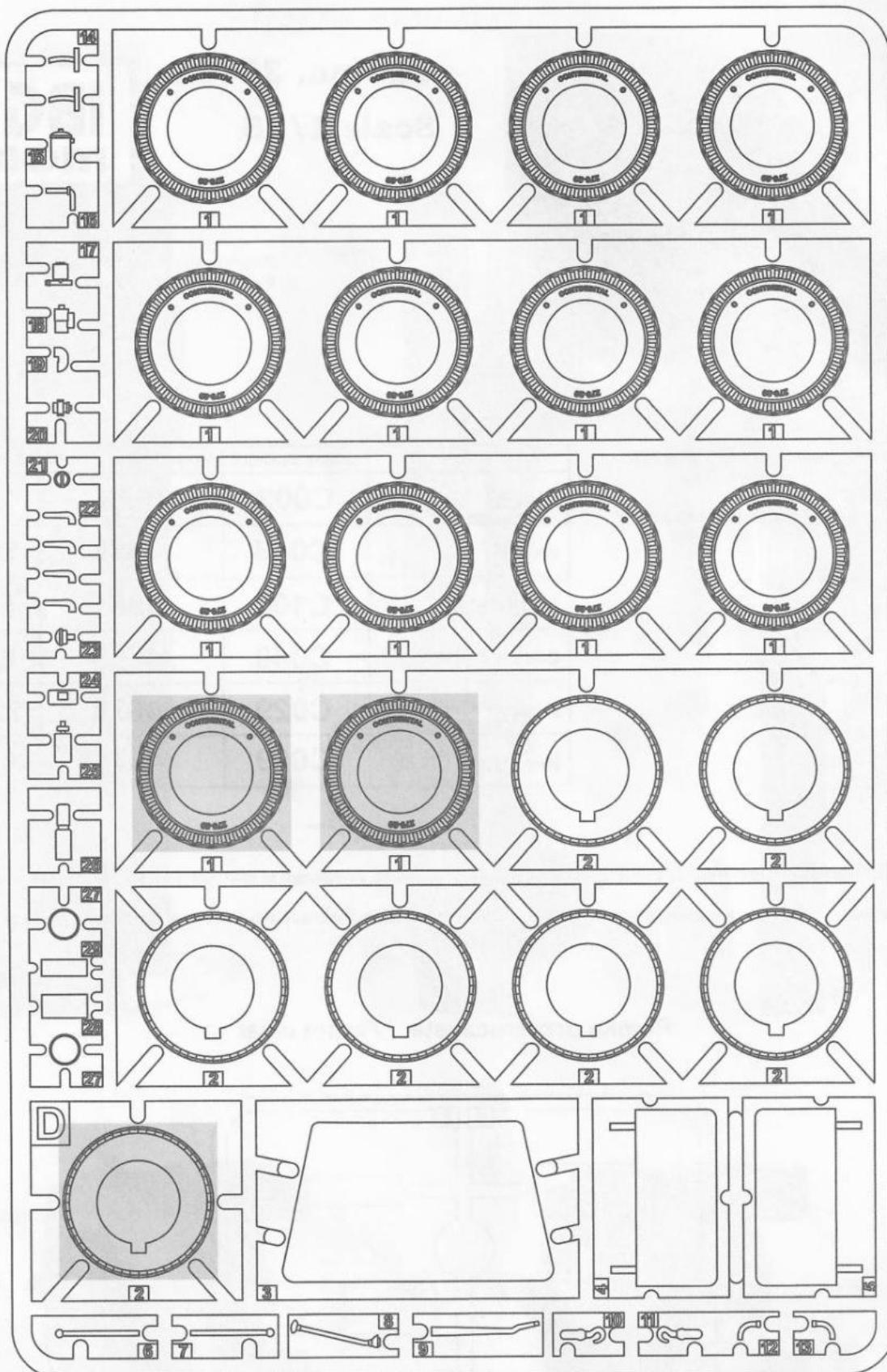

International Business Group
 ul. Benedykta Hertza 2
 04-603 Warszawa
 Poland

tel +48 22 8159150
 fax +48 22 8159151
 ibgsc@ibg.com.pl
 www.ibg.com.pl

Ramka E / Frame E

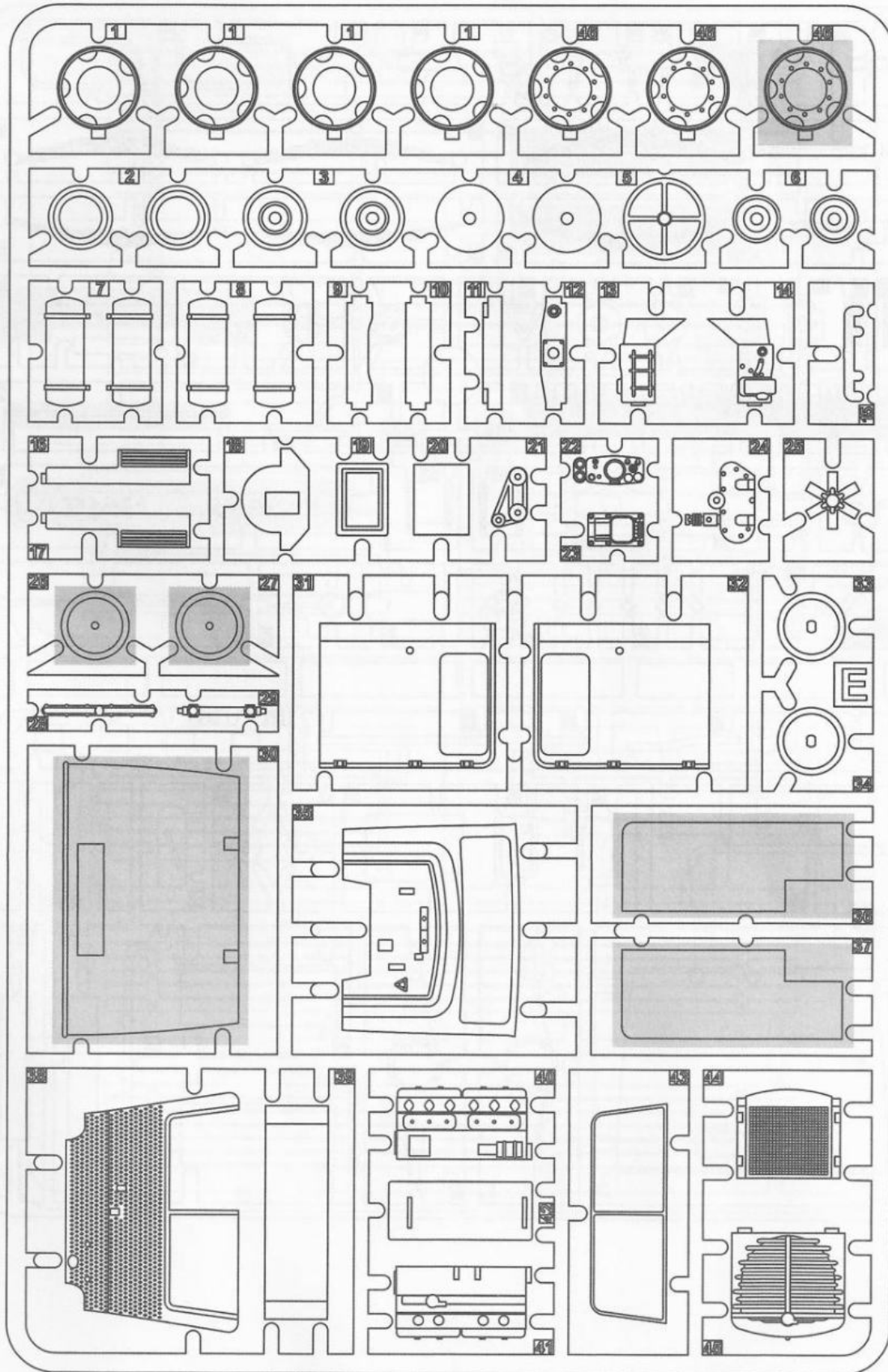

International Business Group
ul. Benedykta Hertzka 2
04-603 Warszawa
Poland

tel +48 22 8159150
fax +48 22 8159151
ibgsc@ibg.com.pl
www.ibg.com.pl

Ramka S i Ramka P / Frame S & Frame P

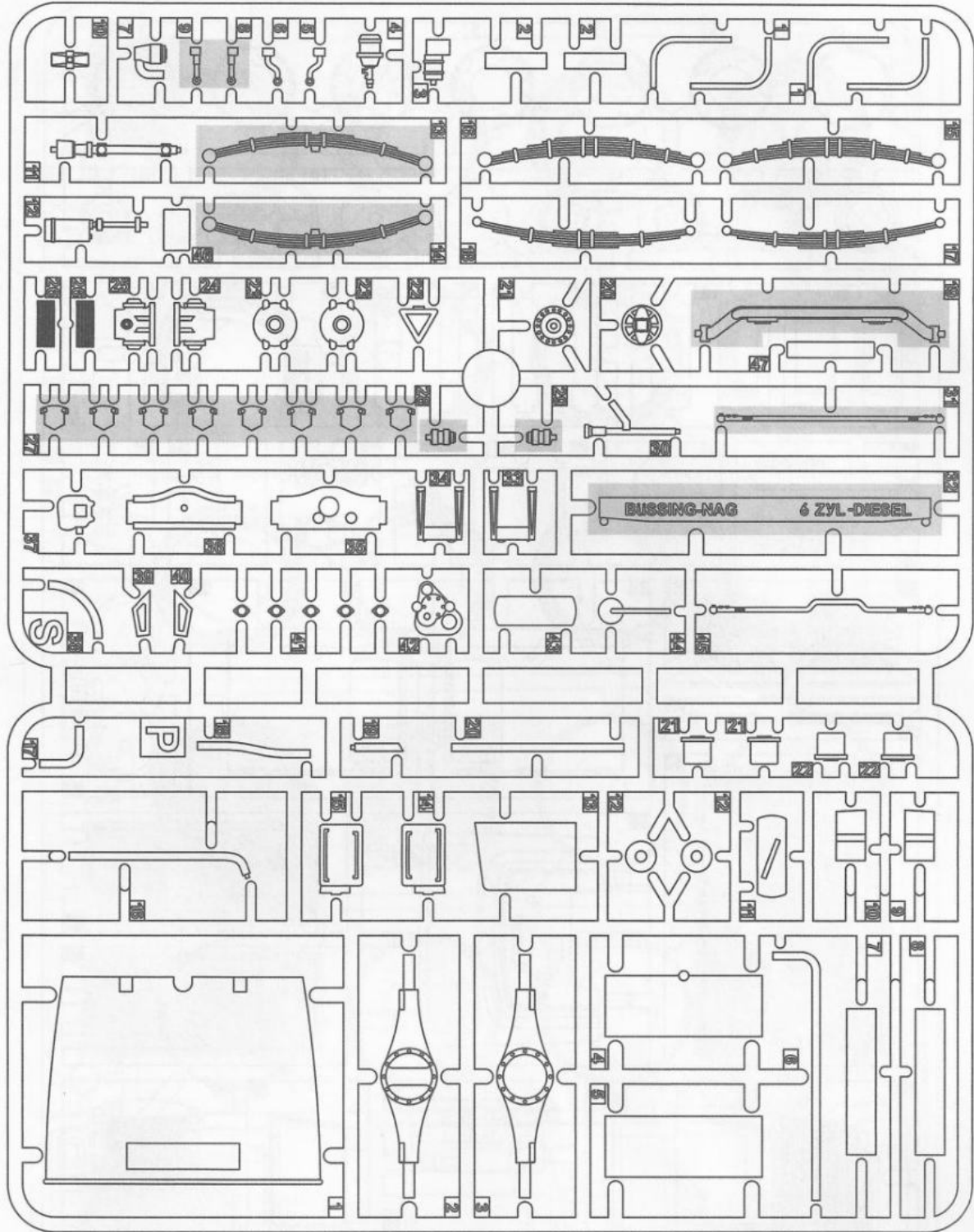

International Business Group
ul. Benedykta Hertza 2
04-603 Warszawa
Poland

tel +48 22 8159150
fax +48 22 8159151
ibgsc@ibg.com.pl
www.ibg.com.pl

Ramka B i Ramka C / *Frame B & Frame C*

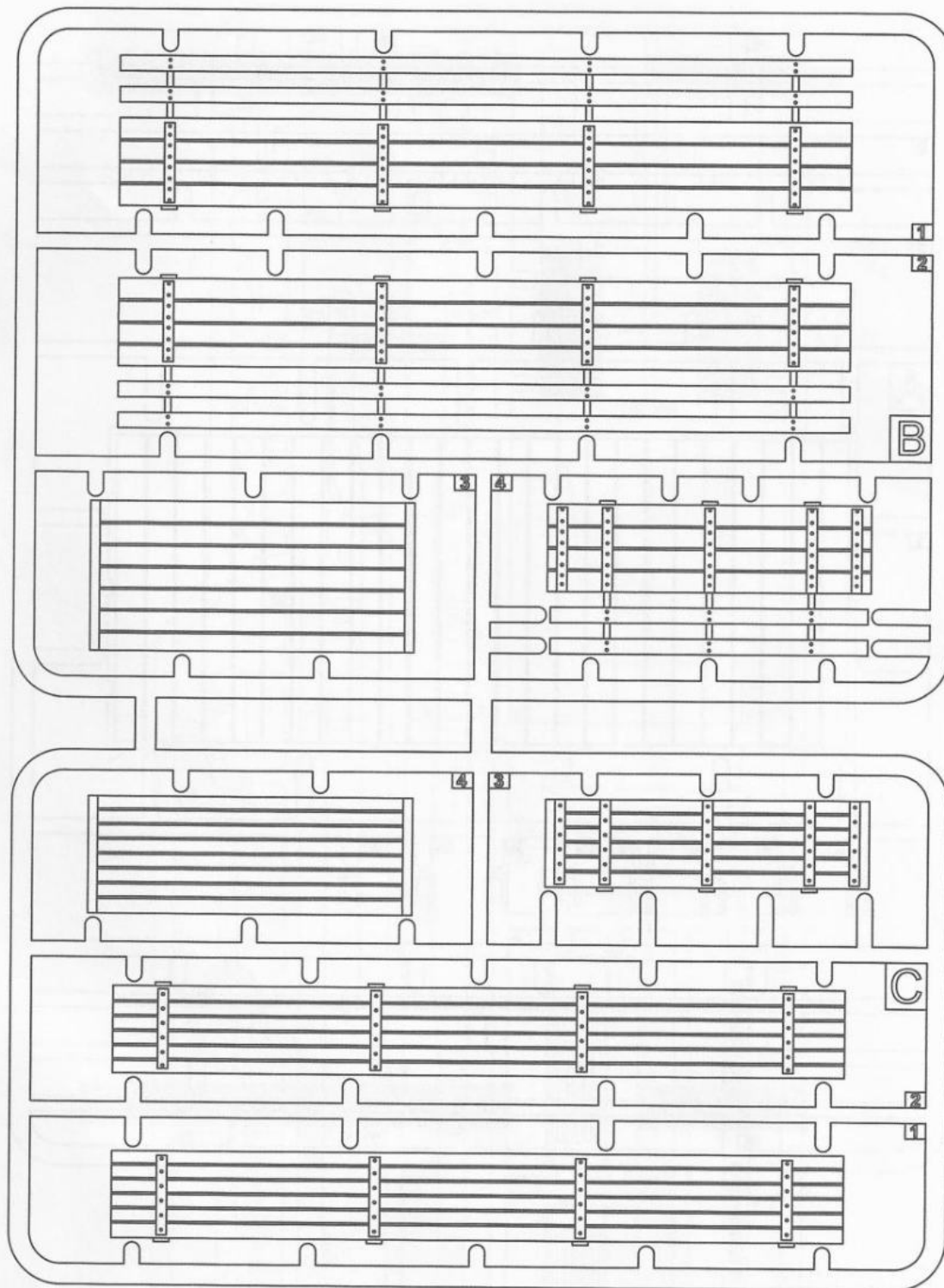

Ramka A / Frame A

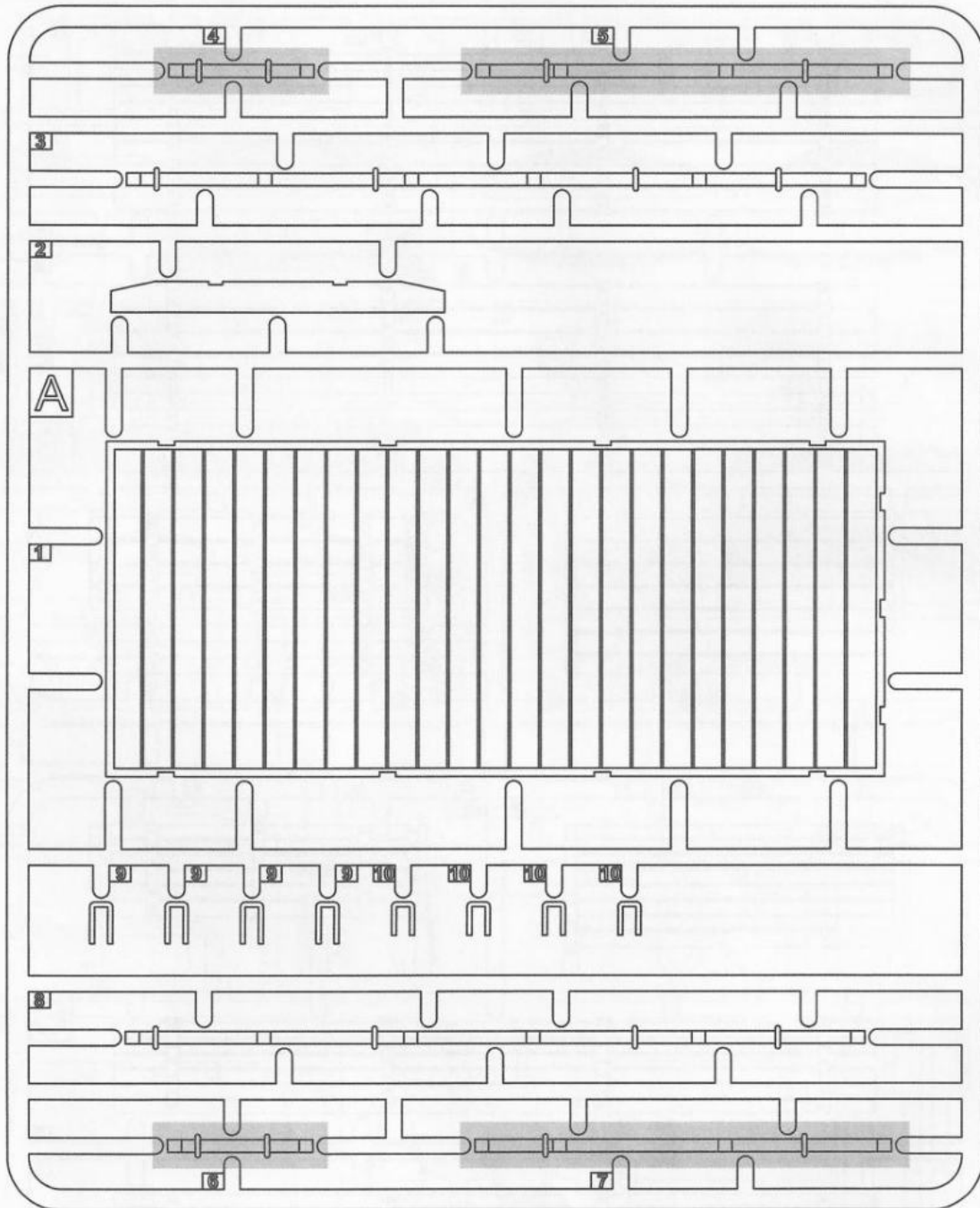

Ramka Z / Frame Z

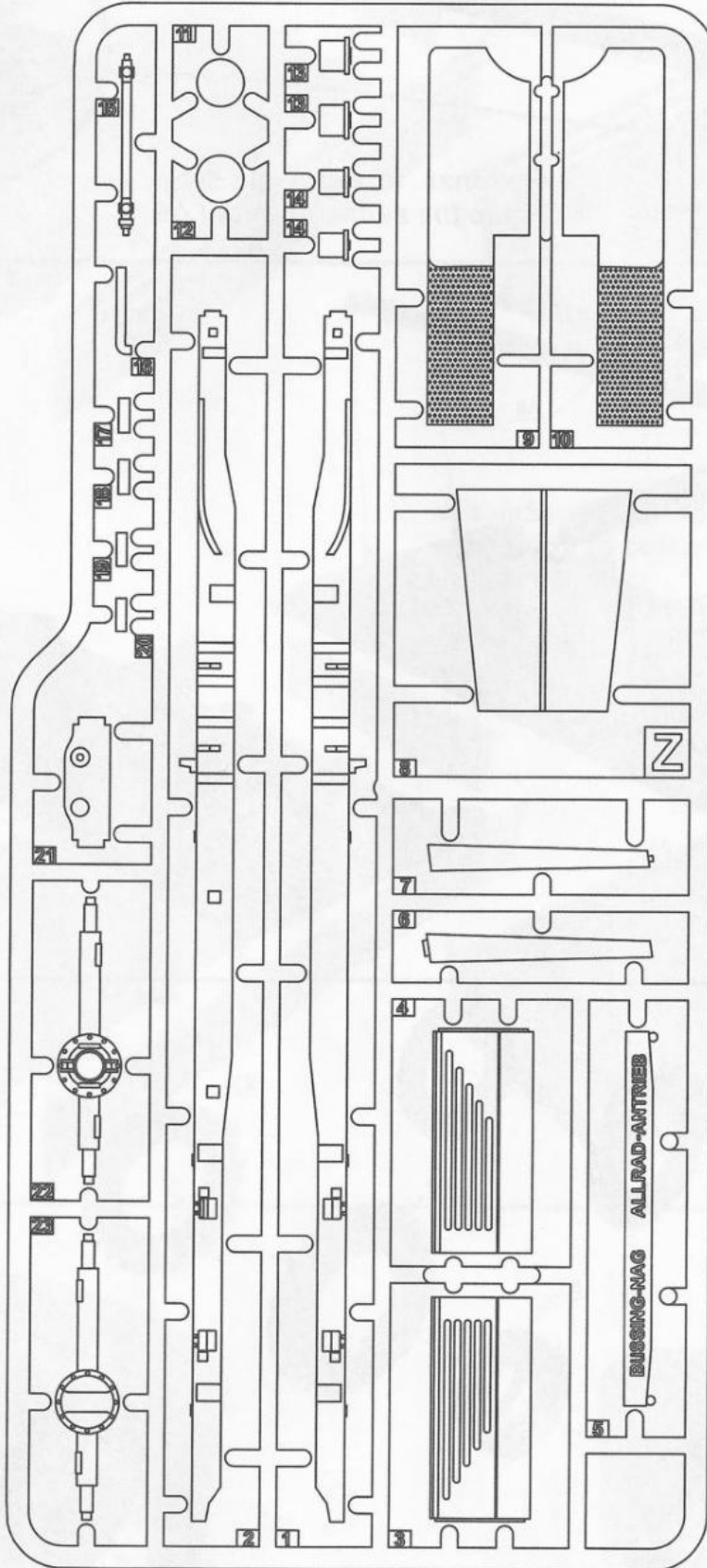

International Business Group
ul. Benedykta Hertzka 2
04-603 Warszawa
Poland

tel +48 22 8159150
fax +48 22 8159151
ibgsc@ibg.com.pl
www.ibg.com.pl

ETAP 1
STEP 1



ETAP 2
STEP 2

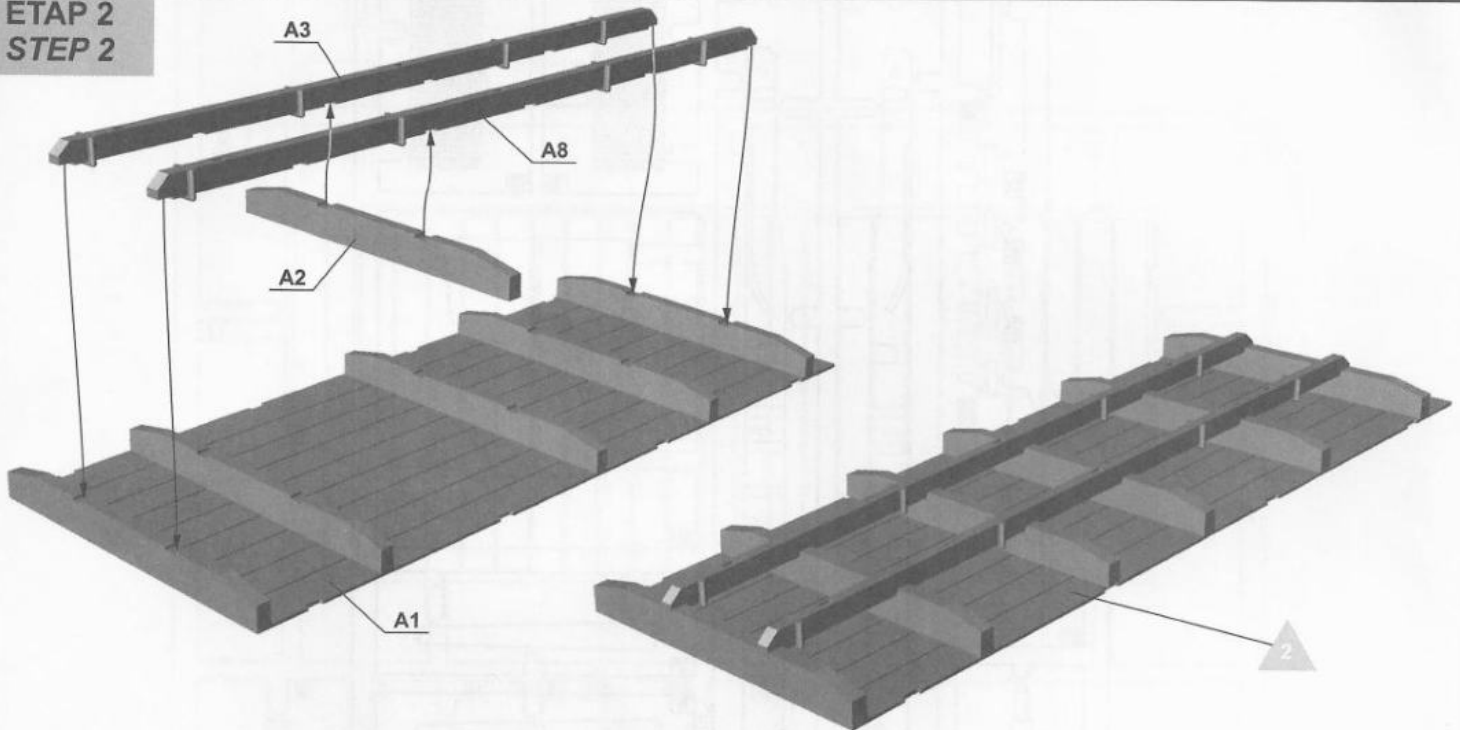

ETAP 3
STEP 3

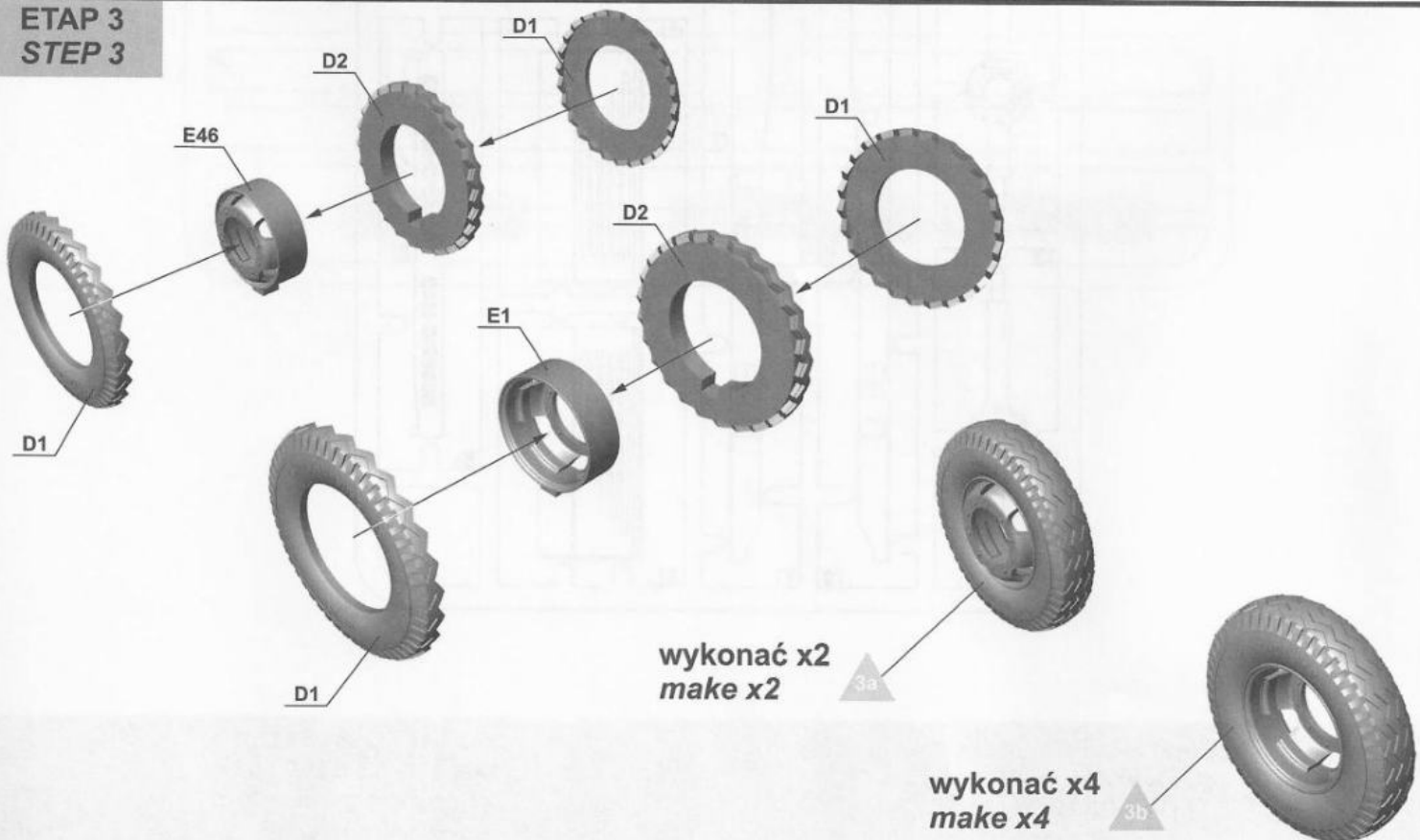

**ETAP 4
STEP 4**

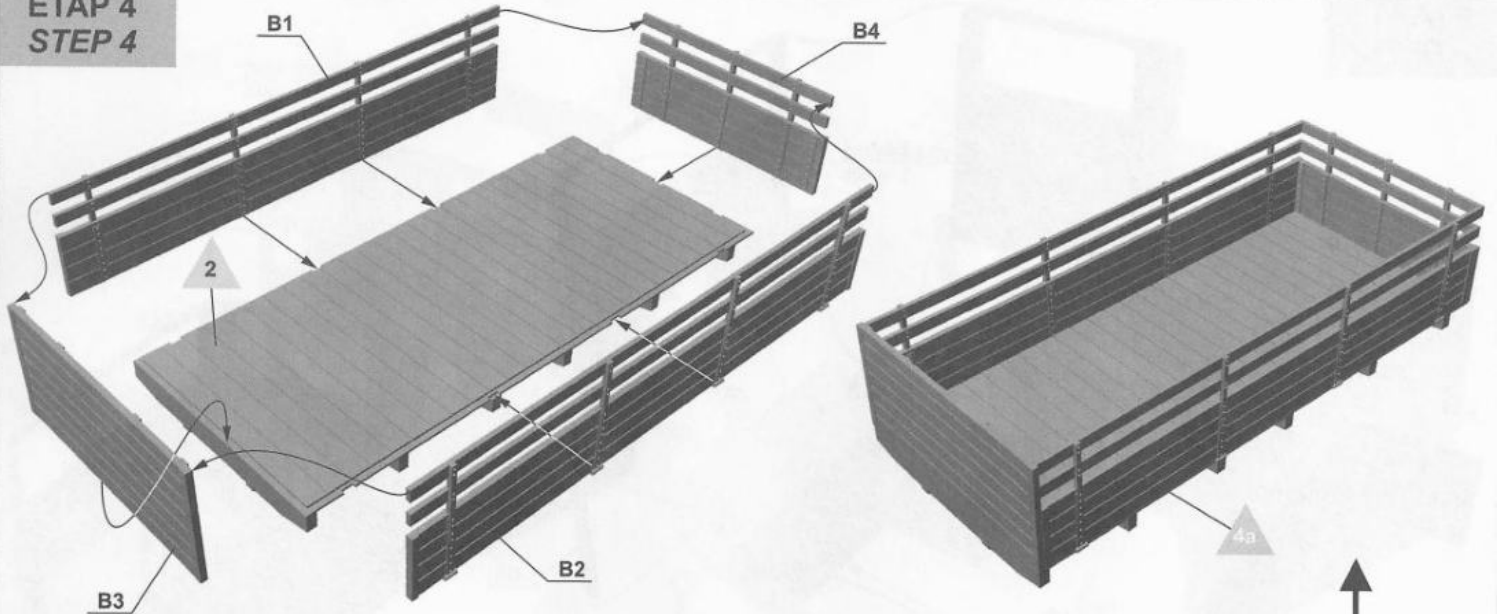

w zależności od wersji malowania
according to colour scheme

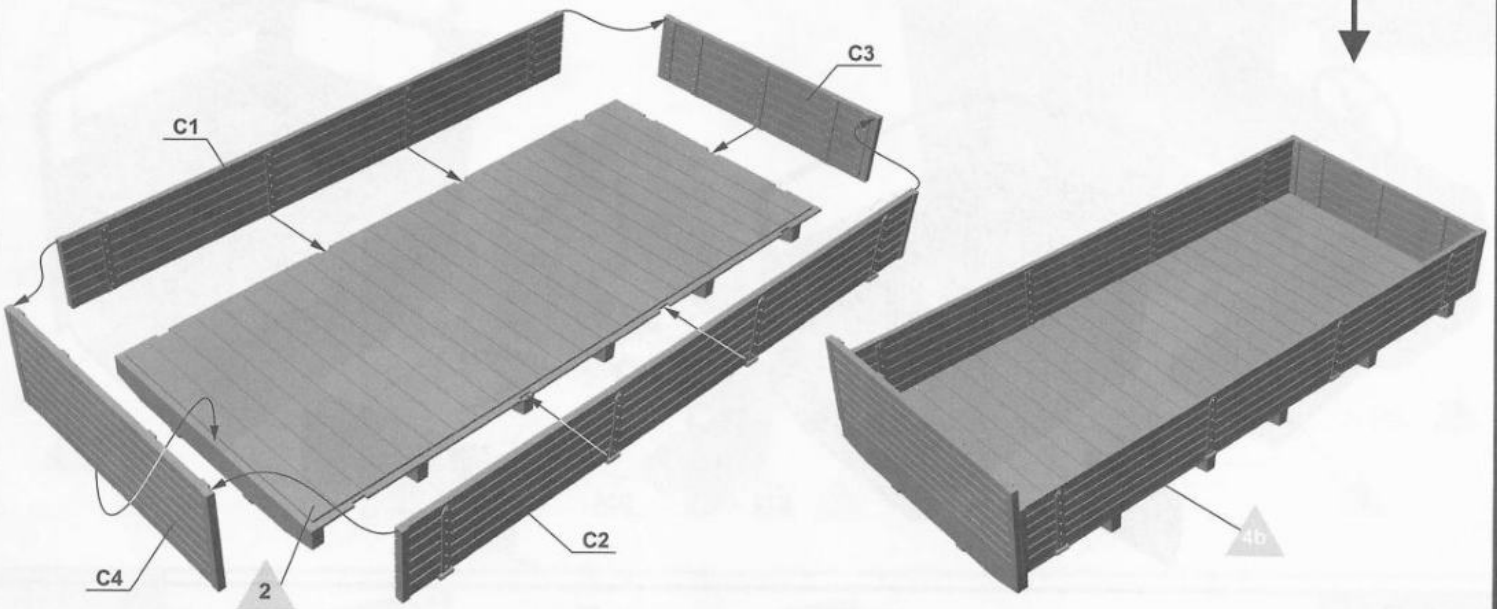
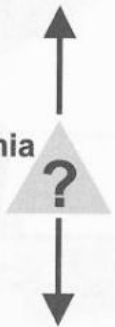

**ETAP 5
STEP 5**

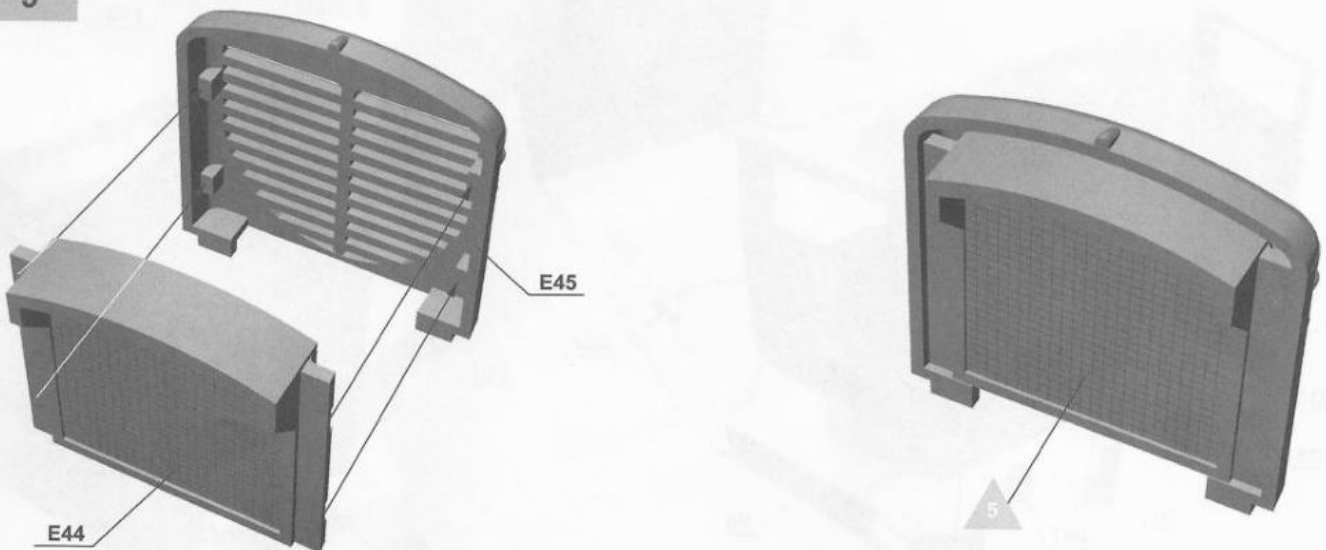

**ETAP 6
STEP 6**

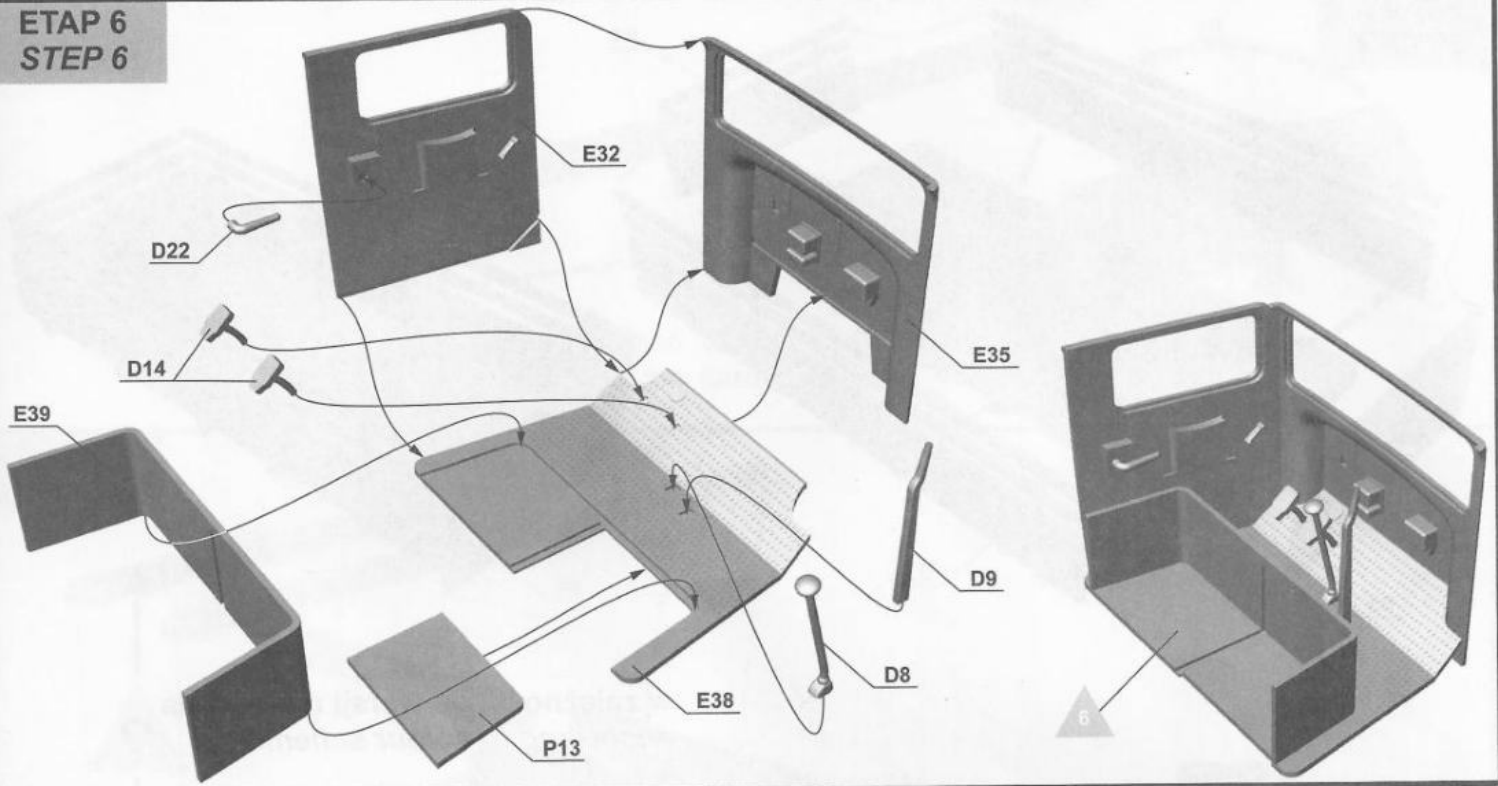

**ETAP 7
STEP 7**

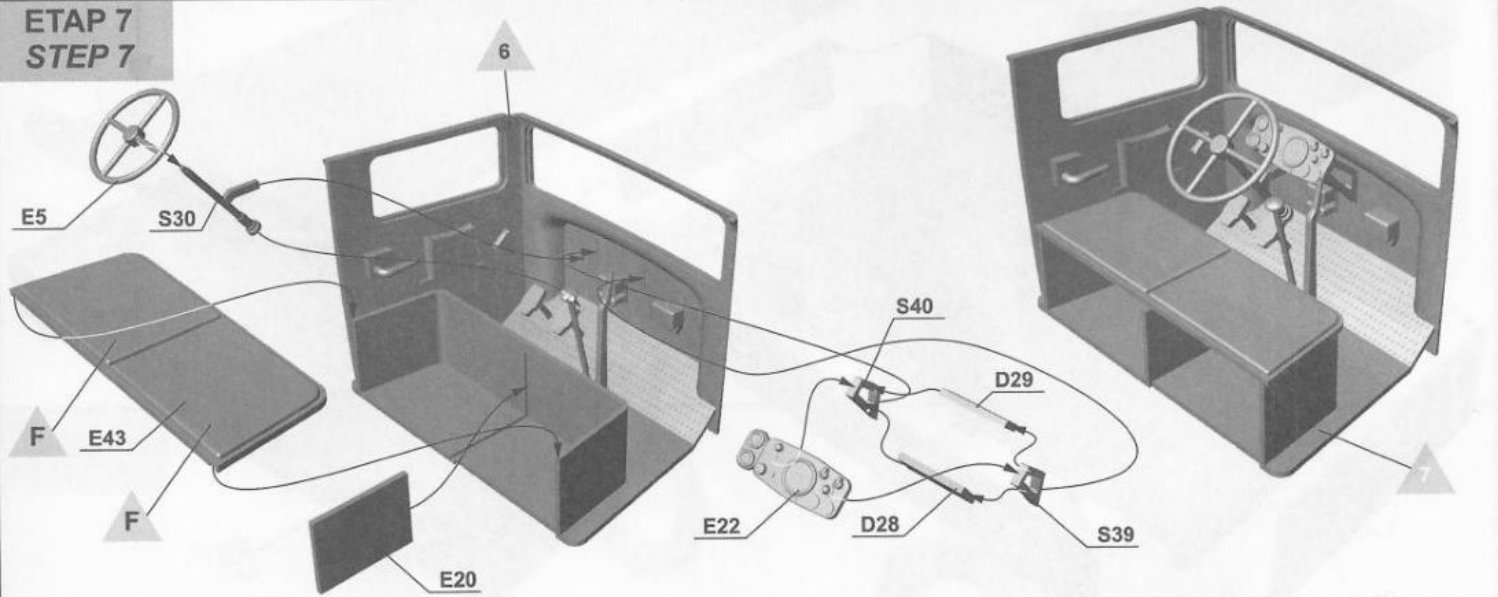

**ETAP 8
STEP 8**

