

TERMINATOR®

ABOUT

The Terminator is an active FET buffer and isolated splitter with a 10 meg ohm input. The 10 meg impedance is ideal for crystal microphone elements and more than adequate for controlled magnetic elements; in other words, it is perfect for your bullet microphone. Your tone will be fatter and you may find that microphones that have been put away now sound great. Good effect pedals will have a true bypass and with a true bypass you will lose the impedance match that the pedal provides causing the tone to be a little thinner, just like playing with no effect pedals at all, the Terminator will prevent this tone loss while in bypass by always providing an optimum impedance match for your microphone. The splitter function allows you to play through two amps at once or go to a PA with the second output, this feature allows for a lot of creativity and a stereo sound while performing. You can have effects with one amp while the other amp is clean, different effects with each amp or anything else you can dream up. There is no gain in the pedal and there is no distortion. One output can be used to feed an amplifier and the second can feed either another amplifier or the LINE (or instrument) input on a PA.

POWER

The Terminator operates off of a 9V battery or a 9V DC power adapter. The AC adapter requirements are 9V DC with a minimum 100mA output and a 2.1mm x 5.5mm connector with a negative center and positive outside. The actual current draw is 4 mA. The battery is switched OFF when an external power supply is used, and the unit is always powered whenever the mic is plugged in. The IN jack acts as the ON/OFF switch and the pedal is ON as long as there is a cable plugged into the IN jack.

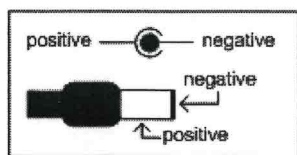
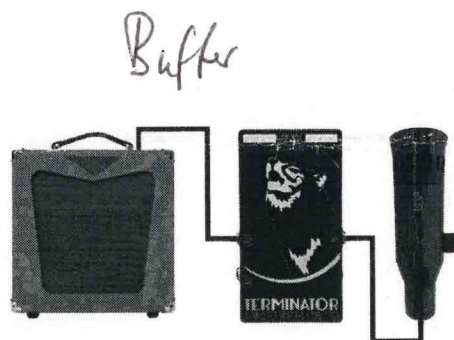
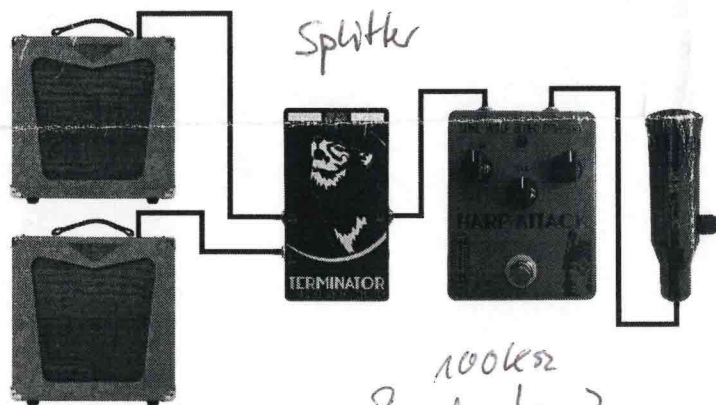

POWER PLUG

*100k Ω
Z_{out} = low Ω*

OUTPUT JACK
Plug amp in here

OUTPUT JACK
Plug amp in here

*Z_{out} 100k Ω
low Ω*



LED
When the LED is ON the effect is on, when it is OFF the unit is in bypass

INPUT JACK
Doubles as an ON/OFF switch

DC POWER PLUG
Requires 9V DC, 100mA or greater output and a 2.1mm x 5.5mm connector with a center negative

*Z_{in} = 10M Ω
Hi- Ω*

FEATURES

1. 10 MEG OHM INPUT IMPEDANCE
2. TWO ISOLATED AMPLIFIER OUTPUTS
3. 9V DC INPUT (BARREL WITH A NEGATIVE CENTER)
4. LED ON/OFF INDICATOR
5. REVERSE POLARITY PROTECTION
6. 10-YEAR WARRANTY ON PARTS AND LABOR
7. IF NOT SATISFIED, RETURN WITHIN 60 DAYS FOR A REFUND OF THE PURCHASE PRICE MINUS 4% CREDIT CARD TRANSACTION FEE

FOR MORE INFORMATION VISIT WWW.LONEWOLFBUES.COM

LONE WOLF
BLUES COMPANY



Prinzip HiZ-Buffer erklärt

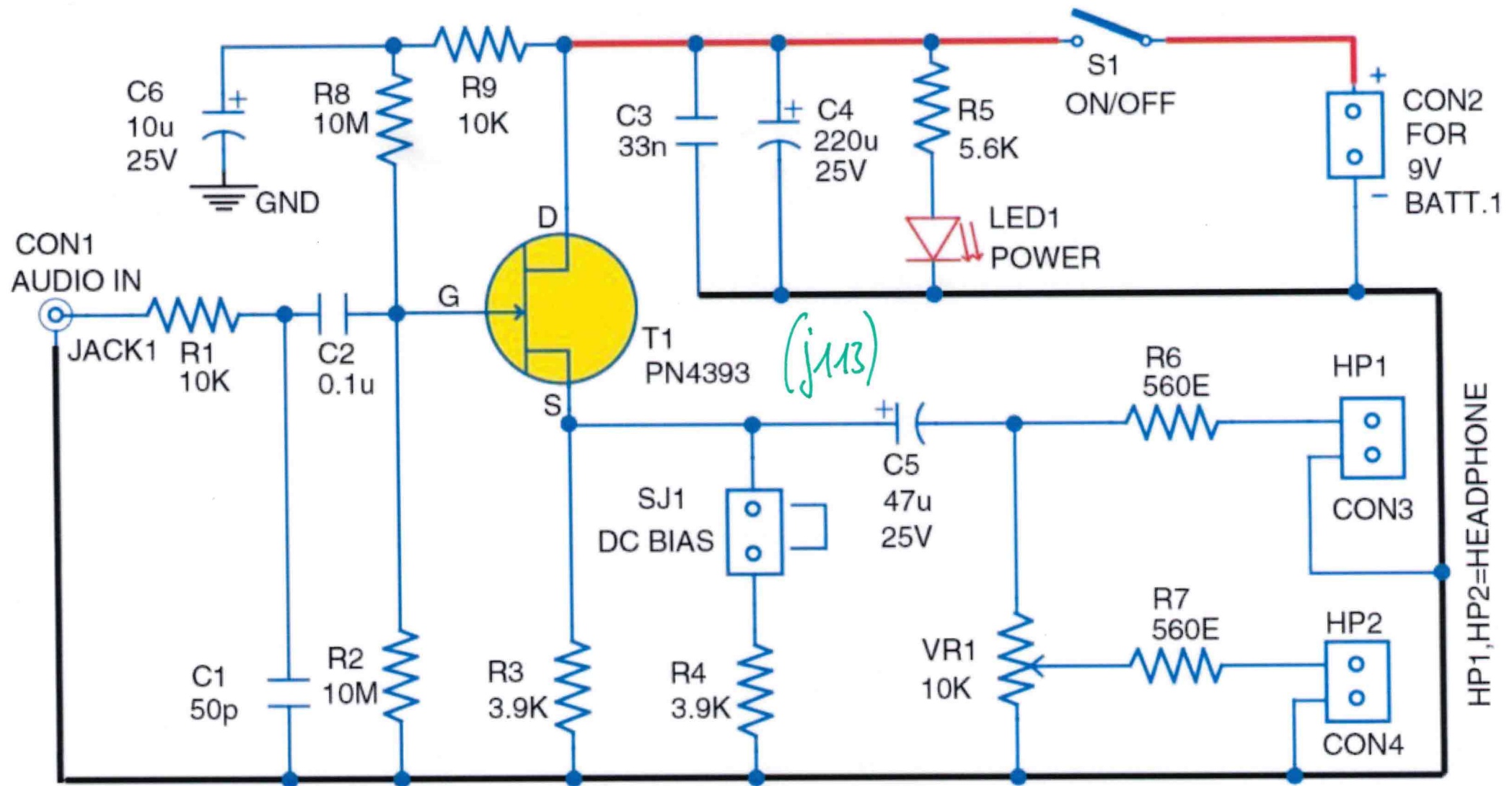

Transistoren:

J113; J201; J202; PN4391; PN4392; PN4393; 2N5457; 2N5458; 2N3819

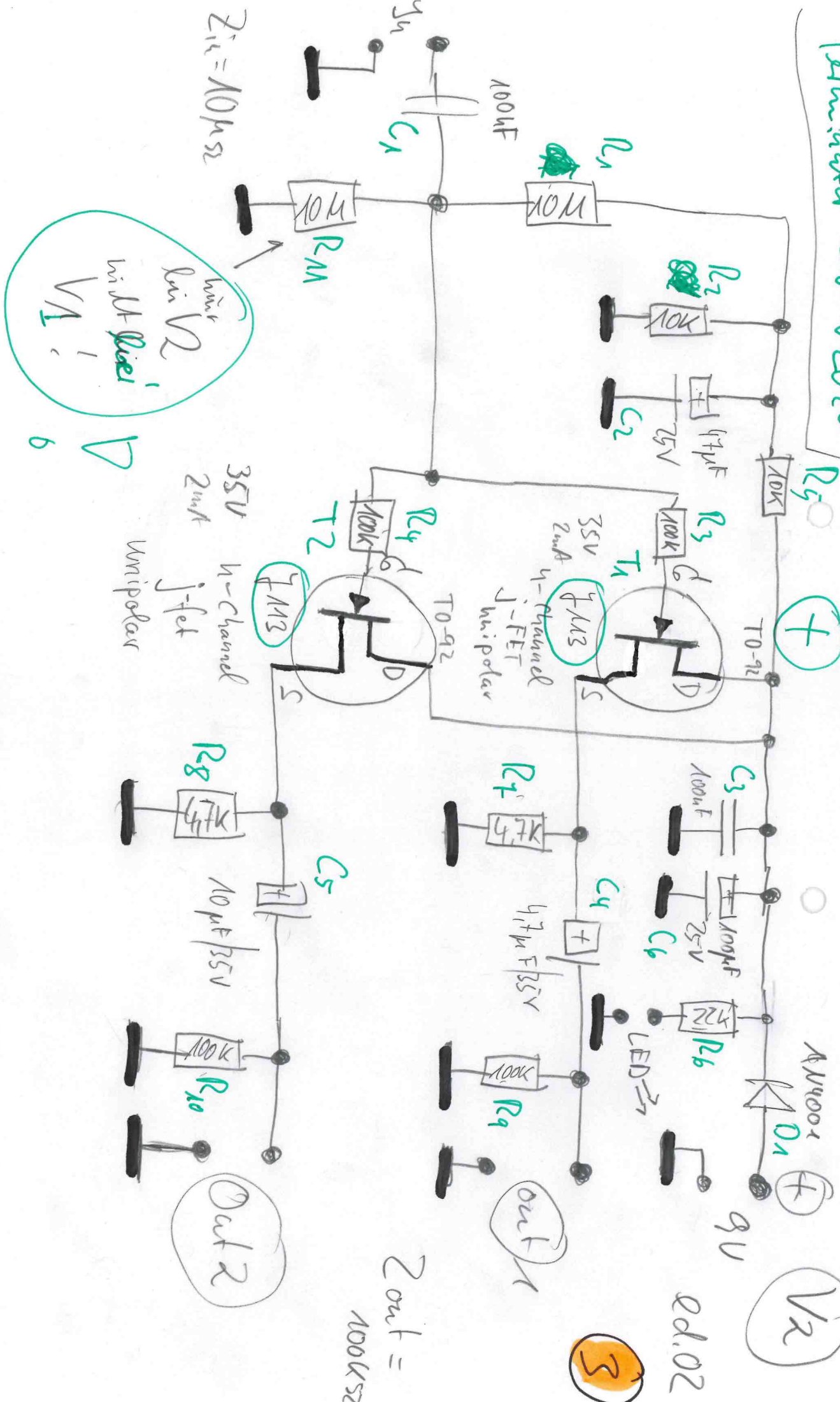

Terminator LW
V2020

ADUS2 Buffer / Splitter MosFET

MosFET

35V 2mA

V2

N-channel
J-FET
unipolar
TO-92

Ed.02

2

Neue
Version
2020

Doppelschicht
PCB mit
VIA
Durchkontaktiert

PCB
Layout

11.03.20
20

LED

J113

J113

